

Willow



**THE
BRENTFORD
PROJECT**



Down
steps
to
the water's
endless
changing
colour



TALLOW ROAD

HALF ACRE ROAD

MARKET SQUARE

BRENTFORD HIGH STREET

ST LAWRENCE GARDENS

CLITHEROW LANE

OAK

BRADSHAW LANE

WILLOW

WEST BRADBURY MENS

EAST BRADBURY MENS

MONTGOMERY

CATHERINE WHEEL LANE

GLOVER

STILL LANE

TURNER

DOCK ROAD

BOARS

CAE LANE

PERCY WAY

BRADBURY YARD

BRUNEL

WORKHOUSE DOCK

HARDWICK

TOWN WHARF

CATHERINE WHEEL YARD

TINTERN

JOHNSONS ISLAND

HERITAGE BOAT YARD

AUGUSTUS CLOSE

ALASTOR RD

THE HAM

THE RIVER BRENT

Ground Floor

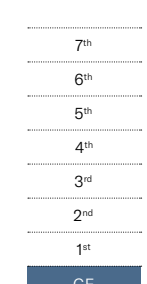
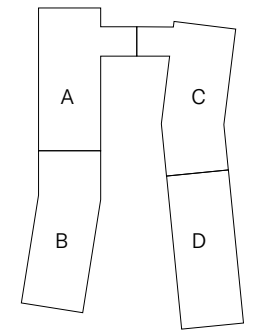

LEGEND
C Commercial
R Retail

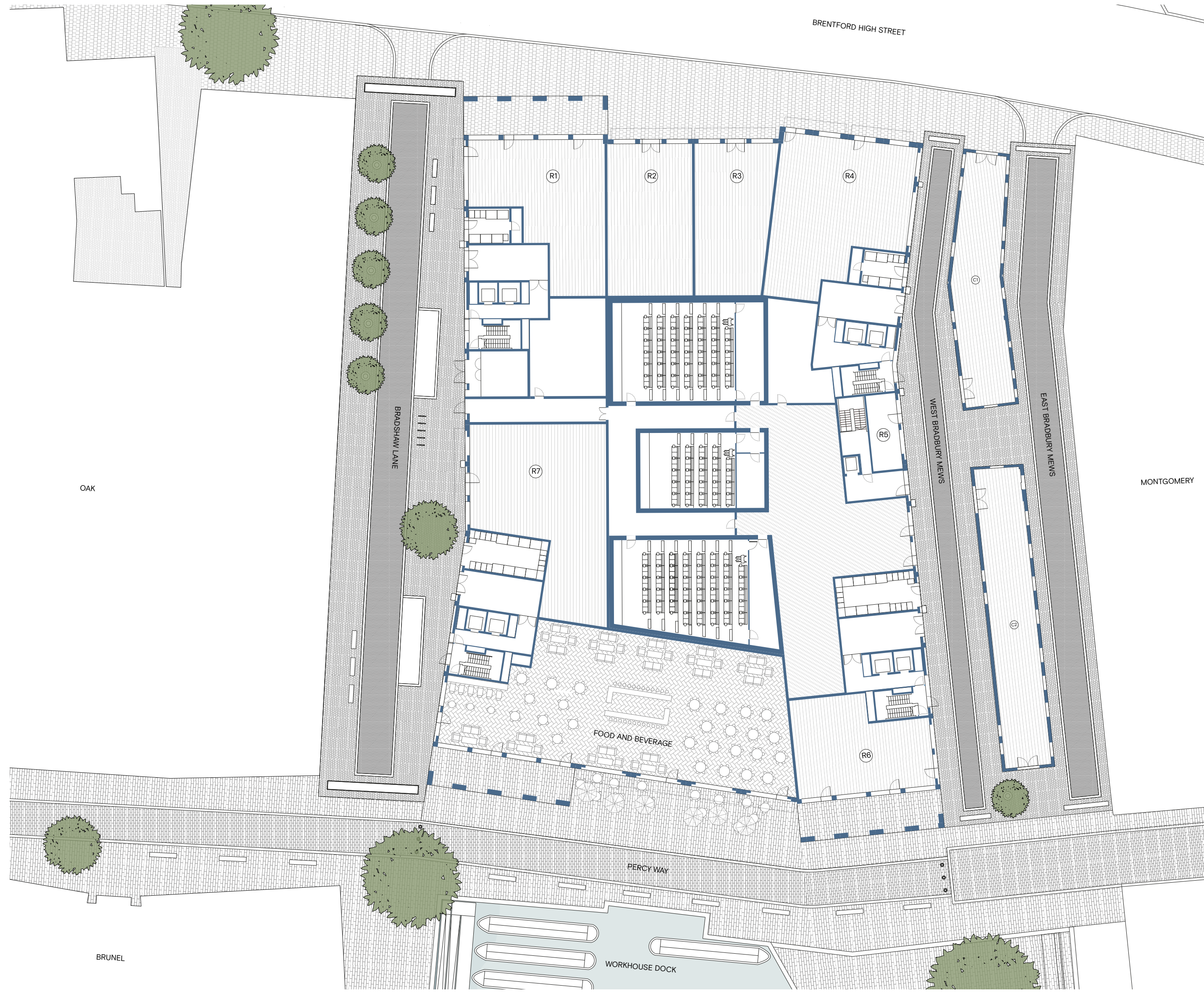
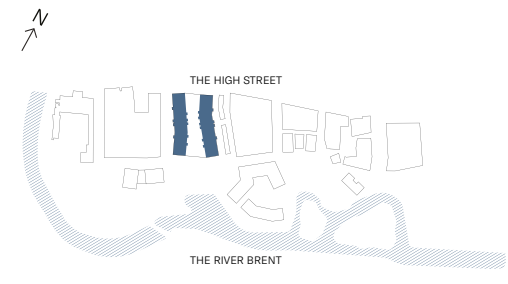

Disclaimer

This brochure and the information contained in it does not form part of any contract, and while reasonable effort has been made to ensure accuracy, this cannot be guaranteed and no representation or warranty is made in that regard. Apartment designs and layouts are indicative only and may change. The specification of the apartments is the anticipated specification as at the date this brochure was prepared, but may be subject to change in accordance with permitted variances under the apartment sale contracts. Dimensions shown in any text or plan are approximate sizes only and actual sizes may be different once constructed (although it is not anticipated that any apartments will be reduced by more than 5% in size). Computer generated images and photos are indicative only. All sales remain subject to contract. All information regarding prospective commercial or retail tenants represents current intention only, and the final identity of the tenants may change. Furniture shown in computer generated images and photos is not included in sales. The Brentford Project is a marketing name only and will not necessarily form part of the approved postal address. Neither the agents nor any person in their employ has any authority to make or give any representation warranty or guarantee (whether written or oral) in respect of or in relation to the development (or any parts thereof). Any dates quoted (including but not limited to completion dates) are estimates only based on current projected development programme and therefore are subject to change. Details of facilities for the development referred to herein are those which are currently anticipated but the developer reserves the right to alter those facilities at its discretion and without notice. In addition where facilities are being provided, they may not be available for use at the time that any given flat sale is due to complete. In addition certain facilities will be located in phase 2 and as such will not be available until the development of phase 2 has been completed.

Willow

Level 01 Podium

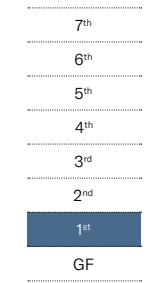
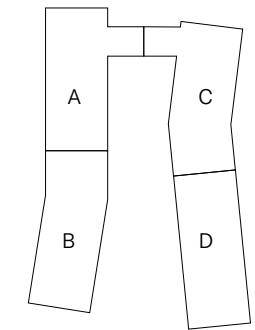
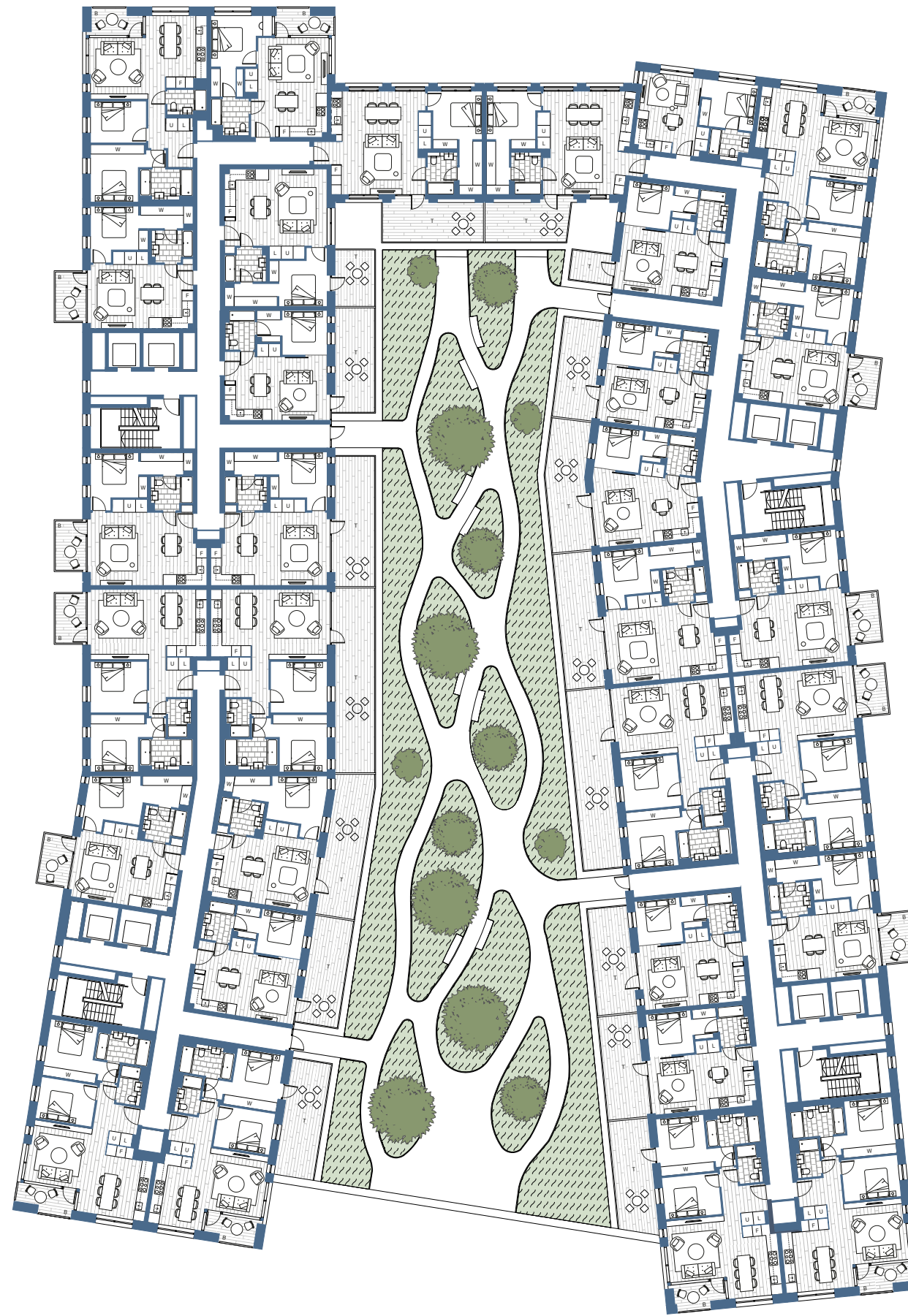

LEGEND

L	Laundry
U	Utility Cupboard
F	Fridge
W	Wardrobe
B	Balcony
T	Terrace

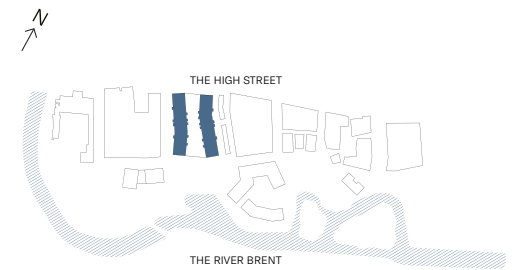

Disclaimer

This brochure and the information contained in it does not form part of any contract, and while reasonable effort has been made to ensure accuracy, this cannot be guaranteed and no representation or warranty is made in that regard. Apartment designs and layouts are indicative only and may change. The specification of the apartments is the anticipated specification as at the date this brochure was prepared, but may be subject to change in accordance with permitted variances under the apartment sale contracts. Dimensions shown in any text or plan are approximate sizes only and actual sizes may be different once constructed (although it is not anticipated that any apartments will be reduced by more than 5% in size). Computer generated images and photos are indicative only. All sales remain subject to contract. All information regarding prospective commercial or retail tenants represents current intention only, and the final identity of the tenants may change. Furniture shown in computer generated images and photos is not included in sales. The Brentford Project is a marketing name only and will not necessarily form part of the approved postal address. Neither the agents nor any person in their employ has any authority to make or give any representation warranty or guarantee (whether written or oral) in respect of or in relation to the development (or any parts thereof). Any dates quoted (including but not limited to completion dates) are estimates only based on current projected development programme and therefore are subject to change. Details of facilities for the development referred to herein are those which are currently anticipated but the developer reserves the right to alter those facilities at its discretion and without notice. In addition where facilities are being provided, they may not be available for use at the time that any given flat sale is due to complete. In addition certain facilities will be located in phase 2 and as such will not be available until the development of phase 2 has been completed.

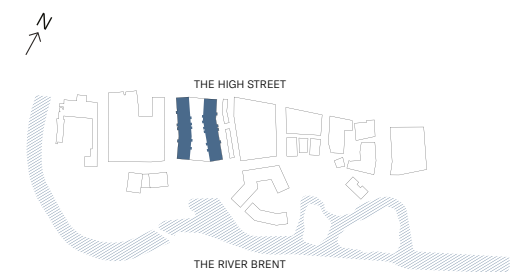
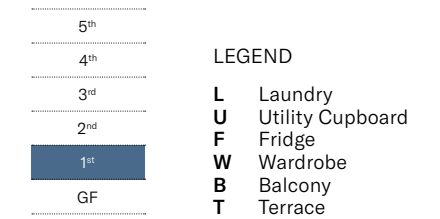
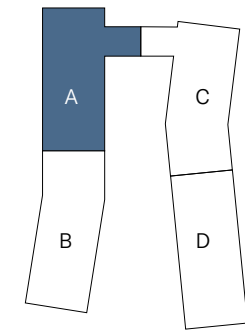

Disclaimer

This brochure and the information contained in it does not form part of any contract, and while reasonable effort has been made to ensure accuracy, this cannot be guaranteed and no representation or warranty is made in that regard. Apartment designs and layouts are indicative only and may change. The specification of the apartments is the anticipated specification as at the date this brochure was prepared, but may be subject to change in accordance with permitted variances under the apartment sale contracts. Dimensions shown in any text or plan are approximate sizes only and actual sizes may be different once constructed (although it is not anticipated that any apartments will be reduced by more than 5% in size). Computer generated images and photos are indicative only. All sales remain subject to contract. All information regarding prospective commercial or retail tenants represents current intention only, and the final identity of the tenants may change. Furniture shown in computer generated images and photos is not included in sales. The Brentford Project is a marketing name only and will not necessarily form part of the approved postal address. Neither the agents nor any person in their employ has any authority to make or give any representation warranty or guarantee (whether written or oral) in respect of or in relation to the development (or any parts thereof). Any dates quoted (including but not limited to completion dates) are estimates only based on current projected development programme and therefore are subject to change. Details of facilities for the development referred to herein are those which are currently anticipated but the developer reserves the right to alter those facilities at its discretion and without notice. In addition where facilities are being provided, they may not be available for use at the time that any given flat sale is due to complete. In addition certain facilities will be located in phase 2 and as such will not be available until the development of phase 2 has been completed.

C.A.01.02 TWO BEDROOM

Internal Area
77.2 sq m / 831 sq ft

Living Area
7355 × 4580 mm

Bedroom 1
3645 × 3025 mm

Bedroom 2
2655 × 3530 mm

Balcony Area
5.1 sq m / 55 sq ft

C.A.01.03 ONE BEDROOM

Internal Area
51.5 sq m / 554 sq ft

Living Area
6300 × 4385 mm

Bedroom
3250 × 2870 mm

Balcony Area
5.7 sq m / 61 sq ft

C.A.01.04 ONE BEDROOM

Internal Area
64.2 sq m / 691 sq ft

Living Area
5985 × 6550 mm

Bedroom
3475 × 3065 mm

Terrace Area
16.0 sq m / 172 sq ft

C.A.01.05 ONE BEDROOM

Internal Area
56.4 sq m / 607 sq ft

Living Area
6480 × 4880 mm

Bedroom
3050 × 3720 mm

Terrace Area
8.9 sq m / 96 sq ft

C.A.01.06 ONE BEDROOM SUITE

Internal Area
45.1 sq m / 485 sq ft

Living Area
6485 × 3995 mm

Bedroom
2880 × 2825 mm

Terrace Area
16.5 sq m / 178 sq ft

C.A.01.07 ONE BEDROOM

Internal Area
57.1 sq m / 615 sq ft

Living Area
7360 × 4630 mm

Bedroom
3720 × 3050 mm

Terrace Area
20.5 sq m / 221 sq ft

C.A.01.01 ONE BEDROOM

Internal Area
50.2 sq m / 540 sq ft

Living Area
6485 × 4055 mm

Bedroom
3050 × 3596 mm

Balcony Area
6.1 sq m / 66 sq ft

C.A.01.08 ONE BEDROOM

Internal Area
56.8 sq m / 611 sq ft

Living Area
7360 × 4630 mm

Bedroom
3670 × 3050 mm

Balcony Area
6.1 sq m / 66 sq ft

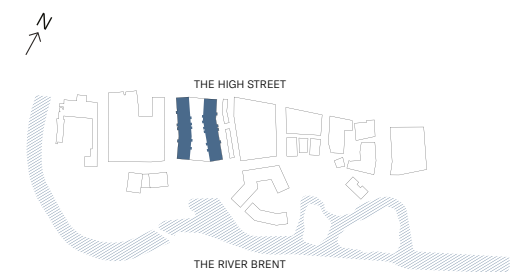
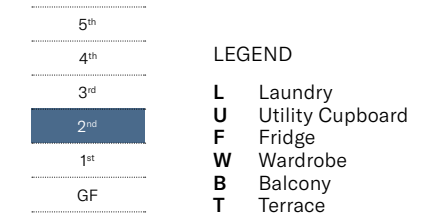
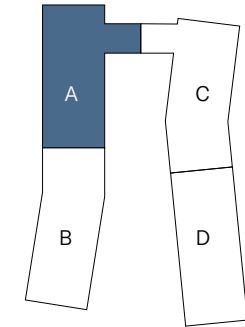

Disclaimer

This brochure and the information contained in it does not form part of any contract, and while reasonable effort has been made to ensure accuracy, this cannot be guaranteed and no representation or warranty is made in that regard. Apartment designs and layouts are indicative only and may change. The specification of the apartments is the anticipated specification as at the date this brochure was prepared, but may be subject to change in accordance with permitted variances under the apartment sale contracts. Dimensions shown in any text or plan are approximate sizes only and actual sizes may be different once constructed (although it is not anticipated that any apartments will be reduced by more than 5% in size). Computer generated images and photos are indicative only. All sales remain subject to contract. All information regarding prospective commercial or retail tenants represents current intention only, and the final identity of the tenants may change. Furniture shown in computer generated images and photos is not included in sales. The Brentford Project is a marketing name only and will not necessarily form part of the approved postal address. Neither the agents nor any person in their employ has any authority to make or give any representation warranty or guarantee (whether written or oral) in respect of or in relation to the development (or any parts thereof). Any dates quoted (including but not limited to completion dates) are estimates only based on current projected development programme and therefore are subject to change. Details of facilities for the development referred to herein are those which are currently anticipated but the developer reserves the right to alter those facilities at its discretion and without notice. In addition where facilities are being provided, they may not be available for use at the time that any given flat sale is due to complete. In addition certain facilities will be located in phase 2 and as such will not be available until the development of phase 2 has been completed.

C.A.02.01 ONE BEDROOM
Internal Area 50.2 sq m / 540 sq ft
Living Area 6485 × 4055 mm
Bedroom 3050 × 3596 mm
Balcony Area 6.1 sq m / 66 sq ft

C.A.02.02 TWO BEDROOM
Internal Area 77.2 sq m / 831 sq ft
Living Area 7355 × 4580 mm
Bedroom 1 3645 × 3025 mm
Bedroom 2 2655 × 3530 mm
Balcony Area 5.7 sq m / 61 sq ft

C.A.02.03 ONE BEDROOM
Internal Area 51.5 sq m / 554 sq ft
Living Area 6300 × 4385 mm
Bedroom 3250 × 2870 mm
Balcony Area 5.1 sq m / 55 sq ft

C.A.02.04 ONE BEDROOM
Internal Area 64.2 sq m / 691 sq ft
Living Area 5985 × 6550 mm
Bedroom 3475 × 3065 mm

C.A.02.05 ONE BEDROOM
Internal Area 56.4 sq m / 607 sq ft
Living Area 6480 × 4880 mm
Bedroom 3050 × 3720 mm

C.A.02.06 ONE BEDROOM
Internal Area 56.4 sq m / 607 sq ft
Living Area 6485 × 4880 mm
Bedroom 3050 × 2900 mm
Balcony Area 6.1 sq m / 66 sq ft

C.A.02.07 ONE BEDROOM
Internal Area 57.1 sq m / 615 sq ft
Living Area 7360 × 4630 mm
Bedroom 3720 × 3050 mm
Balcony Area 6.1 sq m / 66 sq ft

C.A.02.08 ONE BEDROOM
Internal Area 56.8 sq m / 611 sq ft
Living Area 7360 × 4630 mm
Bedroom 3670 × 3050 mm
Balcony Area 6.1 sq m / 66 sq ft

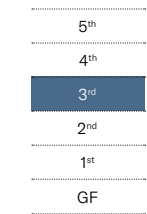
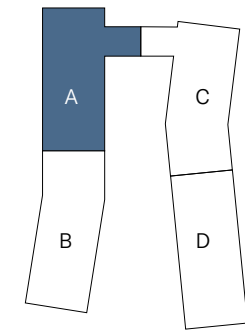

LEGEND

- L Laundry
- U Utility Cupboard
- F Fridge
- W Wardrobe
- B Balcony
- T Terrace

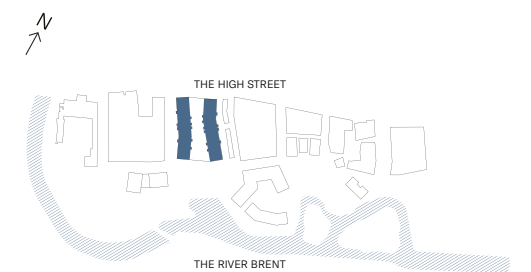

Disclaimer

This brochure and the information contained in it does not form part of any contract, and while reasonable effort has been made to ensure accuracy, this cannot be guaranteed and no representation or warranty is made in that regard. Apartment designs and layouts are indicative only and may change. The specification of the apartments is the anticipated specification as at the date this brochure was prepared, but may be subject to change in accordance with permitted variances under the apartment sale contracts. Dimensions shown in any text or plan are approximate sizes only and actual sizes may be different once constructed (although it is not anticipated that any apartments will be reduced by more than 5% in size). Computer generated images and photos are indicative only. All sales remain subject to contract. All information regarding prospective commercial or retail tenants represents current intention only, and the final identity of the tenants may change. Furniture shown in computer generated images and photos is not included in sales. The Brentford Project is a marketing name only and will not necessarily form part of the approved postal address. Neither the agents nor any person in their employ has any authority to make or give any representation warranty or guarantee (whether written or oral) in respect of or in relation to the development (or any parts thereof). Any dates quoted (including but not limited to completion dates) are estimates only based on current projected development programme and therefore are subject to change. Details of facilities for the development referred to herein are those which are currently anticipated but the developer reserves the right to alter those facilities at its discretion and without notice. In addition where facilities are being provided, they may not be available for use at the time that any given flat sale is due to complete. In addition certain facilities will be located in phase 2 and as such will not be available until the development of phase 2 has been completed.

C.A.03.02 TWO BEDROOM

Internal Area
75.1 sq m / 808 sq ft

Living Area
6910 × 3900 mm

Bedroom 1
3645 × 3025 mm

Bedroom 2
2655 × 3530 mm

Balcony Area
5.1 sq m / 55 sq ft

C.A.03.03 TWO BEDROOM

Internal Area
79.7 sq m / 858 sq ft

Living Area
7805 × 3900 mm

Bedroom 1
3645 × 3025 mm

Bedroom 2
2655 × 3530 mm

Balcony Area
5.7 sq m / 61 sq ft

C.A.03.01 ONE BEDROOM

Internal Area
50.2 sq m / 540 sq ft

Living Area
6485 × 4055 mm

Bedroom
3050 × 3596 mm

Balcony Area
6.1 sq m / 66 sq ft

C.A.03.04 ONE BEDROOM SUITE

Internal Area
41.2 sq m / 443 sq ft

Living Area
6485 × 3530 mm

Bedroom
2855 × 2720 mm

C.A.03.07 ONE BEDROOM

Internal Area
56.8 sq m / 611 sq ft

Living Area
7360 × 4630 mm

Bedroom
3670 × 3050 mm

Balcony Area
6.1 sq m / 66 sq ft

C.A.03.05 ONE BEDROOM

Internal Area
56.4 sq m / 607 sq ft

Living Area
6485 × 4880 mm

Bedroom
3050 × 2900 mm

Balcony Area
6.1 sq m / 66 sq ft

C.A.03.06 ONE BEDROOM

Internal Area
57.1 sq m / 615 sq ft

Living Area
7360 × 4630 mm

Bedroom
3720 × 3050 mm

Balcony Area
6.1 sq m / 66 sq ft

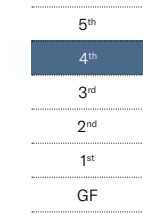
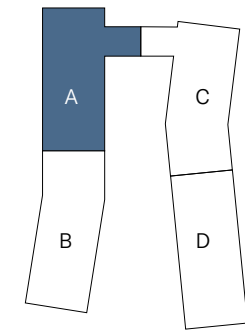

- LEGEND**
- L Laundry
 - U Utility Cupboard
 - F Fridge
 - W Wardrobe
 - B Balcony
 - T Terrace

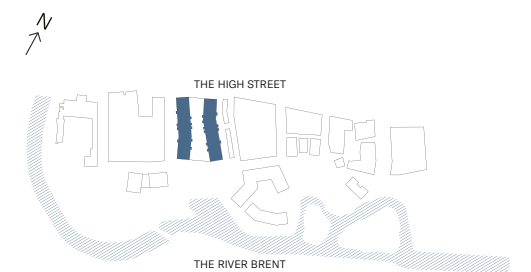

Disclaimer

This brochure and the information contained in it does not form part of any contract, and while reasonable effort has been made to ensure accuracy, this cannot be guaranteed and no representation or warranty is made in that regard. Apartment designs and layouts are indicative only and may change. The specification of the apartments is the anticipated specification as at the date this brochure was prepared, but may be subject to change in accordance with permitted variances under the apartment sale contracts. Dimensions shown in any text or plan are approximate sizes only and actual sizes may be different once constructed (although it is not anticipated that any apartments will be reduced by more than 5% in size). Computer generated images and photos are indicative only. All sales remain subject to contract. All information regarding prospective commercial or retail tenants represents current intention only, and the final identity of the tenants may change. Furniture shown in computer generated images and photos is not included in sales. The Brentford Project is a marketing name only and will not necessarily form part of the approved postal address. Neither the agents nor any person in their employ has any authority to make or give any representation warranty or guarantee (whether written or oral) in respect of or in relation to the development (or any parts thereof). Any dates quoted (including but not limited to completion dates) are estimates only based on current projected development programme and therefore are subject to change. Details of facilities for the development referred to herein are those which are currently anticipated but the developer reserves the right to alter those facilities at its discretion and without notice. In addition where facilities are being provided, they may not be available for use at the time that any given flat sale is due to complete. In addition certain facilities will be located in phase 2 and as such will not be available until the development of phase 2 has been completed.

C.A.04.02 TWO BEDROOM

Internal Area
79.0 sq m / 850 sq ft

Living Area
7805 × 3900 mm

Bedroom 1
3645 × 3025 mm

Bedroom 2
2655 × 3530 mm

Balcony Area
5.7 sq m / 61 sq ft

C.A.04.03 TWO BEDROOM

Internal Area
75.6 sq m / 814 sq ft

Living Area
6910 × 3900 mm

Bedroom 1
3645 × 3025 mm

Bedroom 2
2655 × 3530 mm

Balcony Area
5.1 sq m / 55 sq ft

C.A.04.01 ONE BEDROOM

Internal Area
50.2 sq m / 540 sq ft

Living Area
6485 × 4055 mm

Bedroom
3050 × 3596 mm

Balcony Area
6.1 sq m / 66 sq ft

C.A.04.04 ONE BEDROOM SUITE

Internal Area
41.2 sq m / 443 sq ft

Living Area
6485 × 3530 mm

Bedroom
2855 × 2720 mm

C.A.04.07 ONE BEDROOM

Internal Area
56.8 sq m / 611 sq ft

Living Area
7360 × 4630 mm

Bedroom
3670 × 3050 mm

Balcony Area
6.1 sq m / 66 sq ft

C.A.04.05 ONE BEDROOM

Internal Area
56.4 sq m / 607 sq ft

Living Area
6485 × 4880 mm

Bedroom
3050 × 2900 mm

Balcony Area
6.1 sq m / 66 sq ft

C.A.04.06 ONE BEDROOM

Internal Area
57.1 sq m / 615 sq ft

Living Area
7360 × 4630 mm

Bedroom
3720 × 3050 mm

Balcony Area
6.1 sq m / 66 sq ft

Willow

Level 05 Core A

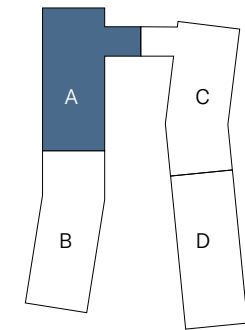
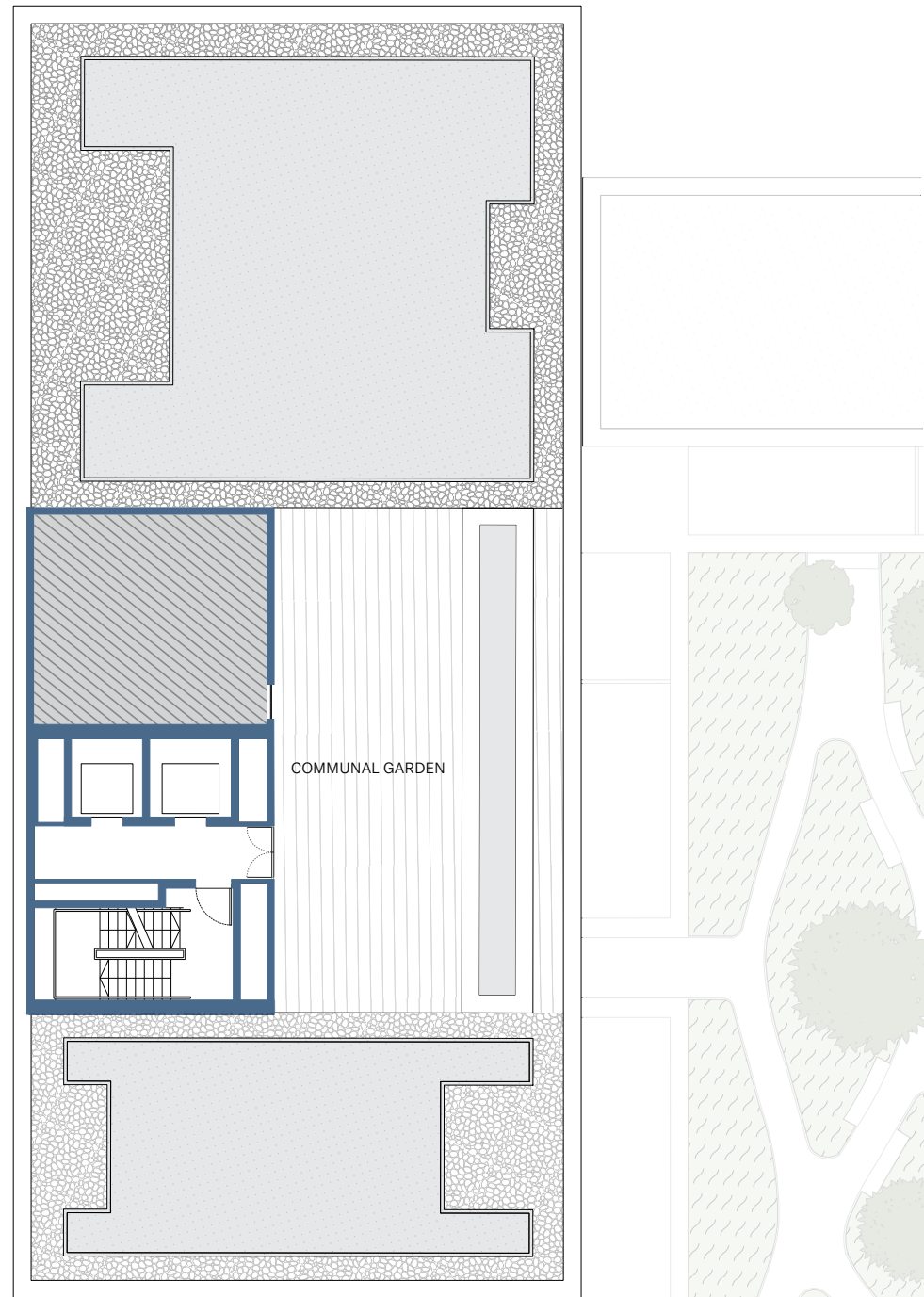

5 th	
4 th	
3 rd	
2 nd	
1 st	
GF	

LEGEND	
L	Laundry
U	Utility Cupboard
F	Fridge
W	Wardrobe
B	Balcony
T	Terrace

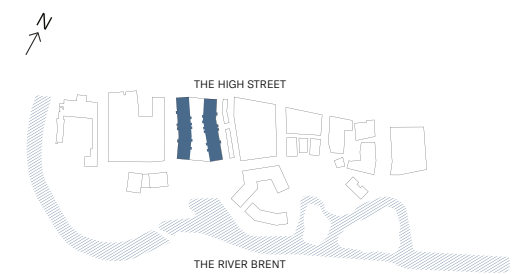

Disclaimer

This brochure and the information contained in it does not form part of any contract, and while reasonable effort has been made to ensure accuracy, this cannot be guaranteed and no representation or warranty is made in that regard. Apartment designs and layouts are indicative only and may change. The specification of the apartments is the anticipated specification as at the date this brochure was prepared, but may be subject to change in accordance with permitted variances under the apartment sale contracts. Dimensions shown in any text or plan are approximate sizes only and actual sizes may be different once constructed (although it is not anticipated that any apartments will be reduced by more than 5% in size). Computer generated images and photos are indicative only. All sales remain subject to contract. All information regarding prospective commercial or retail tenants represents current intention only, and the final identity of the tenants may change. Furniture shown in computer generated images and photos is not included in sales. The Brentford Project is a marketing name only and will not necessarily form part of the approved postal address. Neither the agents nor any person in their employ has any authority to make or give any representation warranty or guarantee (whether written or oral) in respect of or in relation to the development (or any parts thereof). Any dates quoted (including but not limited to completion dates) are estimates only based on current projected development programme and therefore are subject to change. Details of facilities for the development referred to herein are those which are currently anticipated but the developer reserves the right to alter those facilities at its discretion and without notice. In addition where facilities are being provided, they may not be available for use at the time that any given flat sale is due to complete. In addition certain facilities will be located in phase 2 and as such will not be available until the development of phase 2 has been completed.

Level 01 Core B

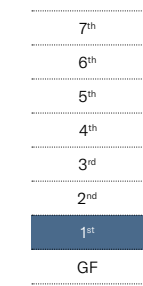
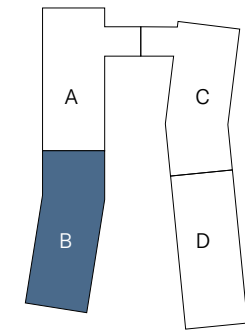

LEGEND

L	Laundry
U	Utility Cupboard
F	Fridge
W	Wardrobe
B	Balcony
T	Terrace

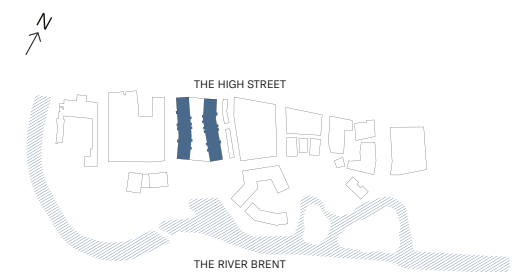

Disclaimer

This brochure and the information contained in it does not form part of any contract, and while reasonable effort has been made to ensure accuracy, this cannot be guaranteed and no representation or warranty is made in that regard. Apartment designs and layouts are indicative only and may change. The specification of the apartments is the anticipated specification as at the date this brochure was prepared, but may be subject to change in accordance with permitted variances under the apartment sale contracts. Dimensions shown in any text or plan are approximate sizes only and actual sizes may be different once constructed (although it is not anticipated that any apartments will be reduced by more than 5% in size). Computer generated images and photos are indicative only. All sales remain subject to contract. All information regarding prospective commercial or retail tenants represents current intention only, and the final identity of the tenants may change. Furniture shown in computer generated images and photos is not included in sales. The Brentford Project is a marketing name only and will not necessarily form part of the approved postal address. Neither the agents nor any person in their employ has any authority to make or give any representation warranty or guarantee (whether written or oral) in respect of or in relation to the development (or any parts thereof). Any dates quoted (including but not limited to completion dates) are estimates only based on current projected development programme and therefore are subject to change. Details of facilities for the development referred to herein are those which are currently anticipated but the developer reserves the right to alter those facilities at its discretion and without notice. In addition where facilities are being provided, they may not be available for use at the time that any given flat sale is due to complete. In addition certain facilities will be located in phase 2 and as such will not be available until the development of phase 2 has been completed.

C.B.01.02 TWO BEDROOM
Internal Area
 78.6 sq m / 846 sq ft
Living Area
 7360 x 4450 mm
Bedroom 1
 3645 x 3025 mm
Bedroom 2
 3255 x 3580 mm
Balcony Area
 6.1 sq m / 66 sq ft

C.B.01.01 ONE BEDROOM
Internal Area
 53.3 sq m / 574 sq ft
Living Area
 6480 x 4205 mm
Bedroom
 3410 x 3240 mm
Balcony Area
 6.1 sq m / 66 sq ft

C.B.01.07 TWO BEDROOM
Internal Area
 76.4 sq m / 822 sq ft
Living Area
 7805 x 3900 mm
Bedroom 1
 3595 x 3025 mm
Bedroom 2
 2655 x 3580 mm
Balcony Area
 5.7 sq m / 61 sq ft

C.B.01.03 TWO BEDROOM
Internal Area
 78.6 sq m / 846 sq ft
Living Area
 7360 x 4450 mm
Bedroom 1
 3645 x 3025 mm
Bedroom 2
 3255 x 3580 mm
Terrace Area
 29.3 sq m / 315 sq ft

C.B.01.04 ONE BEDROOM
Internal Area
 53.0 sq m / 571 sq ft
Living Area
 6485 x 4480 mm
Bedroom
 4090 x 3485 mm
Terrace Area
 22.4 sq m / 241 sq ft

C.B.01.05 ONE BEDROOM SUITE
Internal Area
 45.1 sq m / 485 sq ft
Living Area
 6485 x 4025 mm
Bedroom
 2880 x 2825 mm
Terrace Area
 17.0 sq m / 183 sq ft

C.B.01.06 TWO BEDROOM
Internal Area
 73.3 sq m / 789 sq ft
Living Area
 6905 x 3905 mm
Bedroom 1
 3645 x 3025 mm
Bedroom 2
 2655 x 3580 mm
Balcony & Terrace Area
 23.7 sq m / 255 sq ft



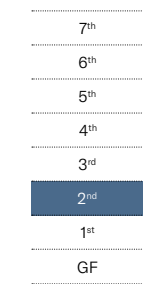
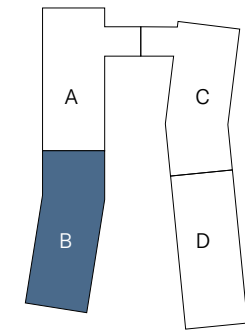

LEGEND

L	Laundry
U	Utility Cupboard
F	Fridge
W	Wardrobe
B	Balcony
T	Terrace

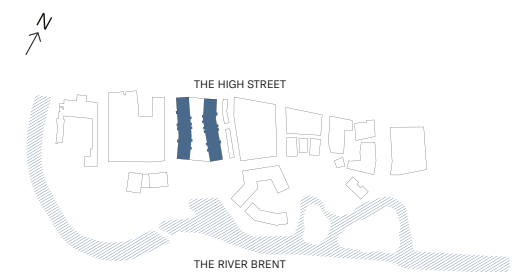

C.B.02.02 TWO BEDROOM
Internal Area
 78.6 sq m / 846 sq ft
Living Area
 7360 x 4450 mm
Bedroom 1
 3645 x 3025 mm
Bedroom 2
 3255 x 3580 mm
Balcony Area
 6.1 sq m / 66 sq ft

C.B.02.03 TWO BEDROOM
Internal Area
 78.6 sq m / 846 sq ft
Living Area
 7360 x 4450 mm
Bedroom 1
 3645 x 3025 mm
Bedroom 2
 3255 x 3580 mm
Balcony Area
 6.1 sq m / 66 sq ft

C.B.02.01 ONE BEDROOM
Internal Area
 53.3 sq m / 574 sq ft
Living Area
 6480 x 4205 mm
Bedroom
 3410 x 3240 mm
Balcony Area
 6.1 sq m / 66 sq ft

C.B.02.04 ONE BEDROOM
Internal Area
 53.0 sq m / 571 sq ft
Living Area
 6485 x 4480 mm
Bedroom
 4090 x 3485 mm
Balcony Area
 5.9 sq m / 64 sq ft

C.B.02.05 ONE BEDROOM
Internal Area
 56.4 sq m / 607 sq ft
Living Area
 6485 x 4880 mm
Bedroom
 3050 x 2900 mm
Balcony Area
 6.1 sq m / 66 sq ft

C.B.02.07 TWO BEDROOM
Internal Area
 72.9 sq m / 785 sq ft
Living Area
 6905 x 3905 mm
Bedroom 1
 3595 x 3025 mm
Bedroom 2
 2655 x 3580 mm
Balcony Area
 5.1 sq m / 55 sq ft

C.B.02.06 TWO BEDROOM
Internal Area
 76.7 sq m / 826 sq ft
Living Area
 7805 x 3900 mm
Bedroom 1
 3645 x 3025 mm
Bedroom 2
 2655 x 3580 mm
Balcony Area
 5.7 sq m / 61 sq ft



Disclaimer

This brochure and the information contained in it does not form part of any contract, and while reasonable effort has been made to ensure accuracy, this cannot be guaranteed and no representation or warranty is made in that regard. Apartment designs and layouts are indicative only and may change. The specification of the apartments is the anticipated specification as at the date this brochure was prepared, but may be subject to change in accordance with permitted variances under the apartment sale contracts. Dimensions shown in any text or plan are approximate sizes only and actual sizes may be different once constructed (although it is not anticipated that any apartments will be reduced by more than 5% in size). Computer generated images and photos are indicative only. All sales remain subject to contract. All information regarding prospective commercial or retail tenants represents current intention only, and the final identity of the tenants may change. Furniture shown in computer generated images and photos is not included in sales. The Brentford Project is a marketing name only and will not necessarily form part of the approved postal address. Neither the agents nor any person in their employ has any authority to make or give any representation warranty or guarantee (whether written or oral) in respect of or in relation to the development (or any parts thereof). Any dates quoted (including but not limited to completion dates) are estimates only based on current projected development programme and therefore are subject to change. Details of facilities for the development referred to herein are those which are currently anticipated but the developer reserves the right to alter those facilities at its discretion and without notice. In addition where facilities are being provided, they may not be available for use at the time that any given flat sale is due to complete. In addition certain facilities will be located in phase 2 and as such will not be available until the development of phase 2 has been completed.

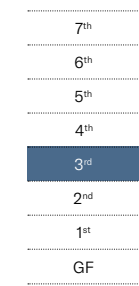
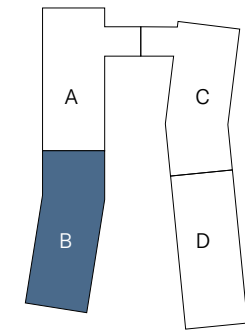

LEGEND

- L Laundry
- U Utility Cupboard
- F Fridge
- W Wardrobe
- B Balcony
- T Terrace

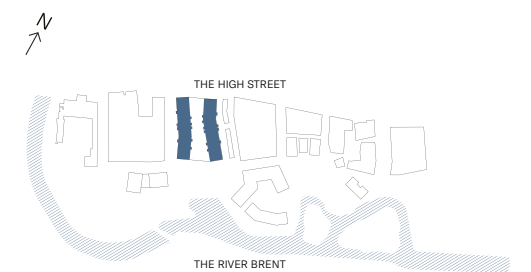

C.B.03.02 TWO BEDROOM
Internal Area
 78.6 sq m / 846 sq ft
Living Area
 7360 × 4450 mm
Bedroom 1
 3645 × 3025 mm
Bedroom 2
 3255 × 3580 mm
Balcony Area
 6.1 sq m / 66 sq ft

C.B.03.03 TWO BEDROOM
Internal Area
 78.6 sq m / 846 sq ft
Living Area
 7360 × 4450 mm
Bedroom 1
 3645 × 3025 mm
Bedroom 2
 3255 × 3580 mm
Balcony Area
 6.1 sq m / 66 sq ft

C.B.03.01 ONE BEDROOM
Internal Area
 53.3 sq m / 574 sq ft
Living Area
 6480 × 4205 mm
Bedroom
 3410 × 3240 mm
Balcony Area
 6.1 sq m / 66 sq ft

C.B.03.04 ONE BEDROOM
Internal Area
 53.0 sq m / 571 sq ft
Living Area
 6485 × 4480 mm
Bedroom
 4090 × 3485 mm
Balcony Area
 5.9 sq m / 64 sq ft

C.B.03.05 ONE BEDROOM
Internal Area
 56.4 sq m / 607 sq ft
Living Area
 6485 × 4880 mm
Bedroom
 3050 × 2900 mm
Balcony Area
 6.1 sq m / 66 sq ft

C.B.03.07 TWO BEDROOM
Internal Area
 76.4 sq m / 822 sq ft
Living Area
 7805 × 3900 mm
Bedroom 1
 3595 × 3025 mm
Bedroom 2
 2655 × 3580 mm
Balcony Area
 5.7 sq m / 61 sq ft

C.B.03.06 TWO BEDROOM
Internal Area
 73.3 sq m / 789 sq ft
Living Area
 6905 × 3905 mm
Bedroom 1
 3645 × 3025 mm
Bedroom 2
 2655 × 3580 mm
Balcony Area
 5.1 sq m / 55 sq ft



Disclaimer

This brochure and the information contained in it does not form part of any contract, and while reasonable effort has been made to ensure accuracy, this cannot be guaranteed and no representation or warranty is made in that regard. Apartment designs and layouts are indicative only and may change. The specification of the apartments is the anticipated specification as at the date this brochure was prepared, but may be subject to change in accordance with permitted variances under the apartment sale contracts. Dimensions shown in any text or plan are approximate sizes only and actual sizes may be different once constructed (although it is not anticipated that any apartments will be reduced by more than 5% in size). Computer generated images and photos are indicative only. All sales remain subject to contract. All information regarding prospective commercial or retail tenants represents current intention only, and the final identity of the tenants may change. Furniture shown in computer generated images and photos is not included in sales. The Brentford Project is a marketing name only and will not necessarily form part of the approved postal address. Neither the agents nor any person in their employ has any authority to make or give any representation warranty or guarantee (whether written or oral) in respect of or in relation to the development (or any parts thereof). Any dates quoted (including but not limited to completion dates) are estimates only based on current projected development programme and therefore are subject to change. Details of facilities for the development referred to herein are those which are currently anticipated but the developer reserves the right to alter those facilities at its discretion and without notice. In addition where facilities are being provided, they may not be available for use at the time that any given flat sale is due to complete. In addition certain facilities will be located in phase 2 and as such will not be available until the development of phase 2 has been completed.

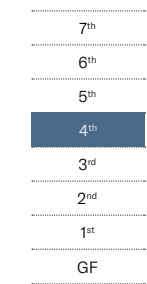
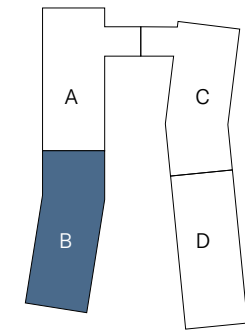

- LEGEND**
- L Laundry
 - U Utility Cupboard
 - F Fridge
 - W Wardrobe
 - B Balcony
 - T Terrace

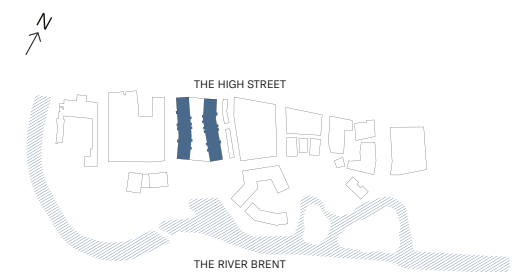

C.B.04.02 TWO BEDROOM
Internal Area
 78.6 sq m / 846 sq ft
Living Area
 7360 x 4450 mm
Bedroom 1
 3645 x 3025 mm
Bedroom 2
 3255 x 3580 mm
Balcony Area
 6.1 sq m / 66 sq ft

C.B.04.03 TWO BEDROOM
Internal Area
 78.6 sq m / 846 sq ft
Living Area
 7360 x 4450 mm
Bedroom 1
 3645 x 3025 mm
Bedroom 2
 3255 x 3580 mm
Balcony Area
 6.1 sq m / 66 sq ft

C.B.04.01 ONE BEDROOM
Internal Area
 53.3 sq m / 574 sq ft
Living Area
 6480 x 4205 mm
Bedroom
 3410 x 3240 mm
Balcony Area
 6.1 sq m / 66 sq ft

C.B.04.04 ONE BEDROOM
Internal Area
 53.0 sq m / 571 sq ft
Living Area
 6485 x 4480 mm
Bedroom
 4090 x 3485 mm
Balcony Area
 5.9 sq m / 64 sq ft

C.B.04.05 ONE BEDROOM
Internal Area
 56.4 sq m / 607 sq ft
Living Area
 6485 x 4880 mm
Bedroom
 3050 x 2900 mm
Balcony Area
 6.1 sq m / 66 sq ft

C.B.04.07 TWO BEDROOM
Internal Area
 72.9 sq m / 785 sq ft
Living Area
 6905 x 3905 mm
Bedroom 1
 3595 x 3025 mm
Bedroom 2
 2655 x 3580 mm
Balcony Area
 5.1 sq m / 55 sq ft

C.B.04.06 TWO BEDROOM
Internal Area
 76.7 sq m / 826 sq ft
Living Area
 7805 x 3900 mm
Bedroom 1
 3645 x 3025 mm
Bedroom 2
 2655 x 3580 mm
Balcony Area
 5.7 sq m / 61 sq ft



Disclaimer

This brochure and the information contained in it does not form part of any contract, and while reasonable effort has been made to ensure accuracy, this cannot be guaranteed and no representation or warranty is made in that regard. Apartment designs and layouts are indicative only and may change. The specification of the apartments is the anticipated specification as at the date this brochure was prepared, but may be subject to change in accordance with permitted variances under the apartment sale contracts. Dimensions shown in any text or plan are approximate sizes only and actual sizes may be different once constructed (although it is not anticipated that any apartments will be reduced by more than 5% in size). Computer generated images and photos are indicative only. All sales remain subject to contract. All information regarding prospective commercial or retail tenants represents current intention only, and the final identity of the tenants may change. Furniture shown in computer generated images and photos is not included in sales. The Brentford Project is a marketing name only and will not necessarily form part of the approved postal address. Neither the agents nor any person in their employ has any authority to make or give any representation warranty or guarantee (whether written or oral) in respect of or in relation to the development (or any parts thereof). Any dates quoted (including but not limited to completion dates) are estimates only based on current projected development programme and therefore are subject to change. Details of facilities for the development referred to herein are those which are currently anticipated but the developer reserves the right to alter those facilities at its discretion and without notice. In addition where facilities are being provided, they may not be available for use at the time that any given flat sale is due to complete. In addition certain facilities will be located in phase 2 and as such will not be available until the development of phase 2 has been completed.

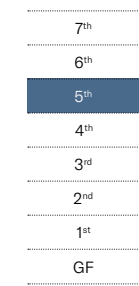
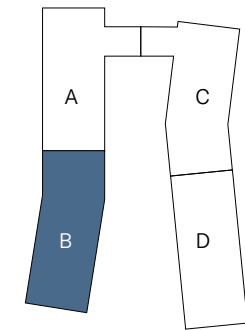

- LEGEND**
- L Laundry
 - U Utility Cupboard
 - F Fridge
 - W Wardrobe
 - B Balcony
 - T Terrace

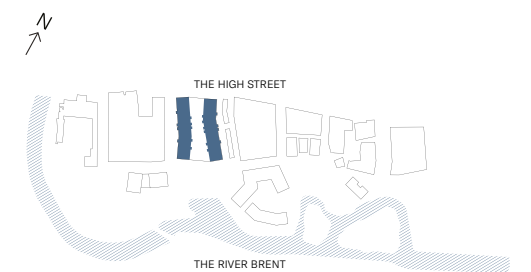

C.B.05.02 TWO BEDROOM
Internal Area
 75.7 sq m / 815 sq ft
Living Area
 6910 × 4440 mm
Bedroom 1
 3645 × 3025 mm
Bedroom 2
 3255 × 3580 mm
Balcony Area
 6.1 sq m / 66 sq ft

C.B.05.01 ONE BEDROOM
Internal Area
 53.3 sq m / 574 sq ft
Living Area
 6480 × 4205 mm
Bedroom
 3410 × 3240 mm
Balcony Area
 6.1 sq m / 66 sq ft

C.B.05.07 TWO BEDROOM
Internal Area
 76.4 sq m / 822 sq ft
Living Area
 7805 × 3900 mm
Bedroom 1
 3595 × 3025 mm
Bedroom 2
 2655 × 3580 mm
Balcony Area
 5.7 sq m / 61 sq ft

C.B.05.03 TWO BEDROOM
Internal Area
 79.4 sq m / 855 sq ft
Living Area
 7810 × 4440 mm
Bedroom 1
 3645 × 3025 mm
Bedroom 2
 3255 × 3580 mm
Balcony Area
 6.1 sq m / 66 sq ft

C.B.05.04 ONE BEDROOM
Internal Area
 53.0 sq m / 571 sq ft
Living Area
 6485 × 4480 mm
Bedroom
 4090 × 3485 mm
Balcony Area
 5.9 sq m / 64 sq ft

C.B.05.05 ONE BEDROOM
Internal Area
 56.4 sq m / 607 sq ft
Living Area
 6485 × 4880 mm
Bedroom
 3050 × 2900 mm
Balcony Area
 6.1 sq m / 66 sq ft

C.B.05.06 TWO BEDROOM
Internal Area
 73.3 sq m / 789 sq ft
Living Area
 6905 × 3905 mm
Bedroom 1
 3645 × 3025 mm
Bedroom 2
 2655 × 3580 mm
Balcony Area
 5.1 sq m / 55 sq ft



Disclaimer

This brochure and the information contained in it does not form part of any contract, and while reasonable effort has been made to ensure accuracy, this cannot be guaranteed and no representation or warranty is made in that regard. Apartment designs and layouts are indicative only and may change. The specification of the apartments is the anticipated specification as at the date this brochure was prepared, but may be subject to change in accordance with permitted variances under the apartment sale contracts. Dimensions shown in any text or plan are approximate sizes only and actual sizes may be different once constructed (although it is not anticipated that any apartments will be reduced by more than 5% in size). Computer generated images and photos are indicative only. All sales remain subject to contract. All information regarding prospective commercial or retail tenants represents current intention only, and the final identity of the tenants may change. Furniture shown in computer generated images and photos is not included in sales. The Brentford Project is a marketing name only and will not necessarily form part of the approved postal address. Neither the agents nor any person in their employ has any authority to make or give any representation warranty or guarantee (whether written or oral) in respect of or in relation to the development (or any parts thereof). Any dates quoted (including but not limited to completion dates) are estimates only based on current projected development programme and therefore are subject to change. Details of facilities for the development referred to herein are those which are currently anticipated but the developer reserves the right to alter those facilities at its discretion and without notice. In addition where facilities are being provided, they may not be available for use at the time that any given flat sale is due to complete. In addition certain facilities will be located in phase 2 and as such will not be available until the development of phase 2 has been completed.

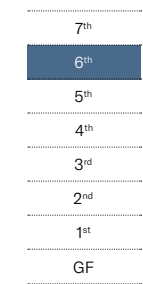
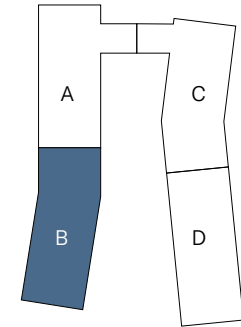

- LEGEND**
- L Laundry
 - U Utility Cupboard
 - F Fridge
 - W Wardrobe
 - B Balcony
 - T Terrace

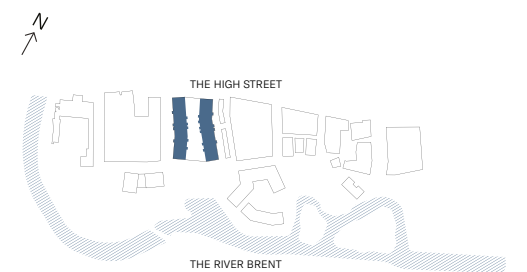

C.B.06.02 TWO BEDROOM
Internal Area
 79.4 sq m / 855 sq ft
Living Area
 7810 × 4440 mm
Bedroom 1
 3645 × 3025 mm
Bedroom 2
 3255 × 3580 mm
Balcony Area
 6.1 sq m / 66 sq ft

C.B.06.01 ONE BEDROOM
Internal Area
 53.3 sq m / 574 sq ft
Living Area
 6480 × 4205 mm
Bedroom
 3410 × 3240 mm
Balcony Area
 6.1 sq m / 66 sq ft

C.B.06.06 TWO BEDROOM
Internal Area
 72.9 sq m / 785 sq ft
Living Area
 6905 × 3905 mm
Bedroom 1
 3595 × 3025 mm
Bedroom 2
 2655 × 3580 mm
Balcony Area
 5.1 sq m / 55 sq ft

C.B.06.03 THREE BEDROOM
Internal Area
 128.5 sq m / 1383 sq ft
Living Area
 6905 × 5835 mm
Bedroom 1
 3645 × 3020 mm
Bedroom 2
 3200 × 3480 mm
Bedroom 3
 3325 × 3480 mm
Balcony & Terrace Area
 97.9 sq m / 1054 sq ft

C.B.06.04 ONE BEDROOM
Internal Area
 56.4 sq m / 607 sq ft
Living Area
 6485 × 4880 mm
Bedroom
 3720 × 3050 mm
Balcony Area
 5.9 sq m / 64 sq ft

C.B.06.05 THREE BEDROOM
Internal Area
 127.2 sq m / 1369 sq ft
Living Area
 7810 × 4005 mm
Bedroom 1
 4330 × 3025 mm
Bedroom 2
 2900 × 3580 mm
Bedroom 3
 2900 × 3580 mm
Balcony & Terrace Area
 94.3 sq m / 1015 sq ft



Disclaimer

This brochure and the information contained in it does not form part of any contract, and while reasonable effort has been made to ensure accuracy, this cannot be guaranteed and no representation or warranty is made in that regard. Apartment designs and layouts are indicative only and may change. The specification of the apartments is the anticipated specification as at the date this brochure was prepared, but may be subject to change in accordance with permitted variances under the apartment sale contracts. Dimensions shown in any text or plan are approximate sizes only and actual sizes may be different once constructed (although it is not anticipated that any apartments will be reduced by more than 5% in size). Computer generated images and photos are indicative only. All sales remain subject to contract. All information regarding prospective commercial or retail tenants represents current intention only, and the final identity of the tenants may change. Furniture shown in computer generated images and photos is not included in sales. The Brentford Project is a marketing name only and will not necessarily form part of the approved postal address. Neither the agents nor any person in their employ has any authority to make or give any representation warranty or guarantee (whether written or oral) in respect of or in relation to the development (or any parts thereof). Any dates quoted (including but not limited to completion dates) are estimates only based on current projected development programme and therefore are subject to change. Details of facilities for the development referred to herein are those which are currently anticipated but the developer reserves the right to alter those facilities at its discretion and without notice. In addition where facilities are being provided, they may not be available for use at the time that any given flat sale is due to complete. In addition certain facilities will be located in phase 2 and as such will not be available until the development of phase 2 has been completed.

Level 07 Core B

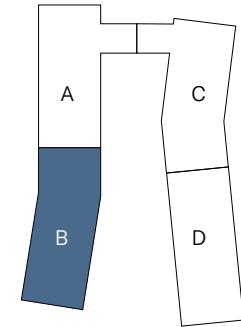

LEGEND

L	Laundry
U	Utility Cupboard
F	Fridge
W	Wardrobe
B	Balcony
T	Terrace

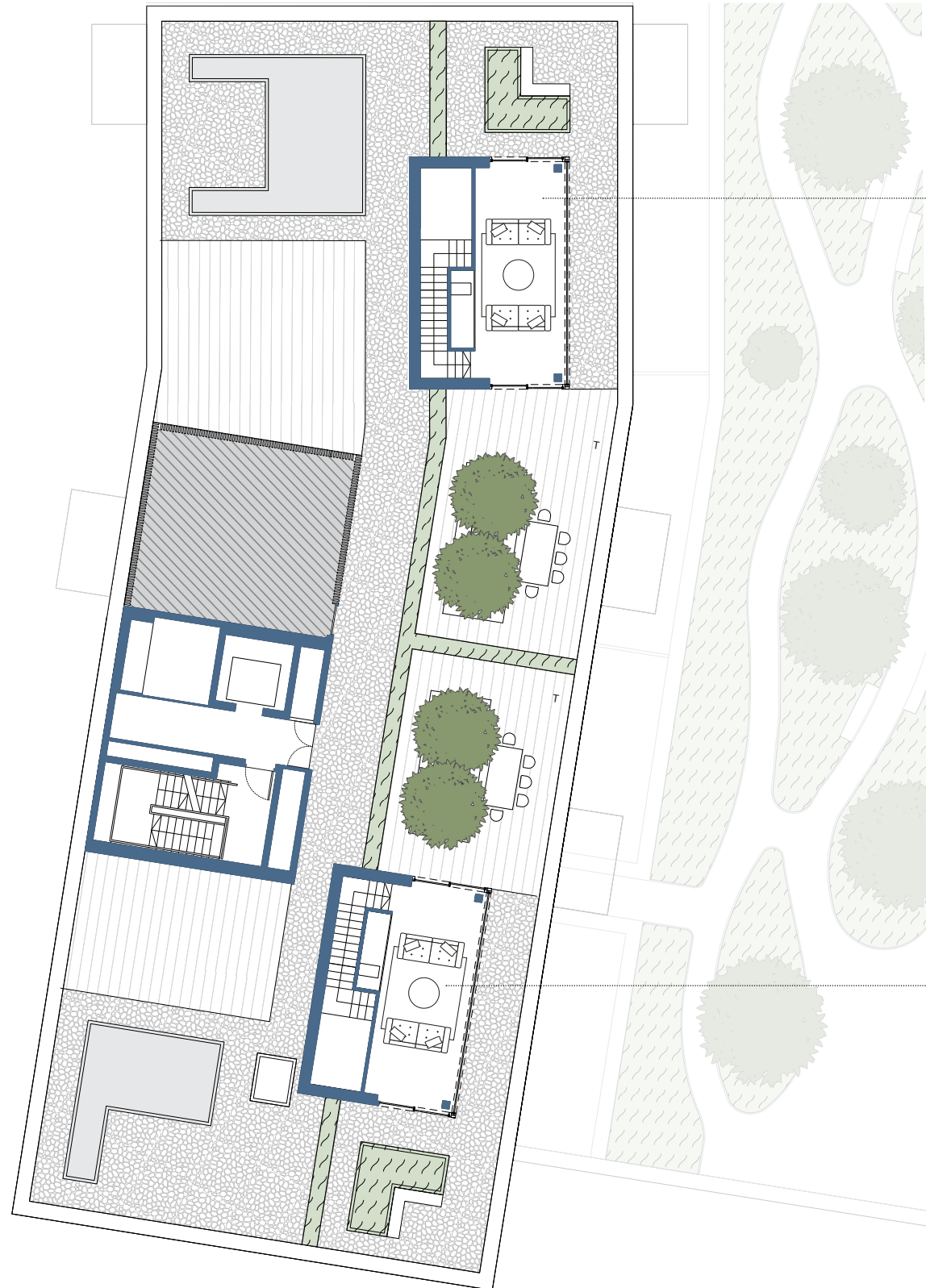
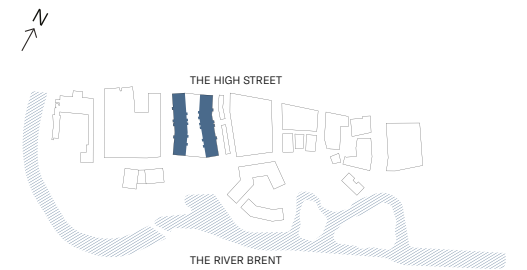

C.B.06.03 THREE BEDROOM
Internal Area
 128.5 sq m / 1383 sq ft
Balcony & Terrace Area
 97.9 sq m / 1054 sq ft

C.B.06.05 THREE BEDROOM
Internal Area
 127.2 sq m / 1369 sq ft
Balcony & Terrace Area
 94.3 sq m / 1015 sq ft

Disclaimer

This brochure and the information contained in it does not form part of any contract, and while reasonable effort has been made to ensure accuracy, this cannot be guaranteed and no representation or warranty is made in that regard. Apartment designs and layouts are indicative only and may change. The specification of the apartments is the anticipated specification as at the date this brochure was prepared, but may be subject to change in accordance with permitted variances under the apartment sale contracts. Dimensions shown in any text or plan are approximate sizes only and actual sizes may be different once constructed (although it is not anticipated that any apartments will be reduced by more than 5% in size). Computer generated images and photos are indicative only. All sales remain subject to contract. All information regarding prospective commercial or retail tenants represents current intention only, and the final identity of the tenants may change. Furniture shown in computer generated images and photos is not included in sales. The Brentford Project is a marketing name only and will not necessarily form part of the approved postal address. Neither the agents nor any person in their employ has any authority to make or give any representation warranty or guarantee (whether written or oral) in respect of or in relation to the development (or any parts thereof). Any dates quoted (including but not limited to completion dates) are estimates only based on current projected development programme and therefore are subject to change. Details of facilities for the development referred to herein are those which are currently anticipated but the developer reserves the right to alter those facilities at its discretion and without notice. In addition where facilities are being provided, they may not be available for use at the time that any given flat sale is due to complete. In addition certain facilities will be located in phase 2 and as such will not be available until the development of phase 2 has been completed.

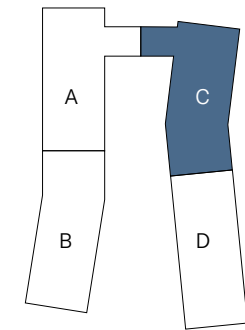

C.C.01.06 ONE BEDROOM

Internal Area
61.2 sq m / 659 sq ft
Living Area
5920 × 6550 mm
Bedroom
3475 × 3065 mm
Terrace Area
13.2 sq m / 142 sq ft

C.C.01.05 ONE BEDROOM SUITE

Internal Area
45.1 sq m / 485 sq ft
Living Area
6485 × 4025 mm
Bedroom
2880 × 2825 mm
Terrace Area
4.7 sq m / 51 sq ft

C.C.01.04 ONE BEDROOM SUITE

Internal Area
41.5 sq m / 447 sq ft
Living Area
6485 × 3580 mm
Bedroom
2885 × 2720 mm
Terrace Area
15.9 sq m / 171 sq ft

C.C.01.03 ONE BEDROOM SUITE

Internal Area
45.9 sq m / 494 sq ft
Living Area
6485 × 5060 mm
Bedroom
2855 × 2720 mm
Terrace Area
20.7 sq m / 223 sq ft

C.C.01.02 ONE BEDROOM

Internal Area
57.1 sq m / 615 sq ft
Living Area
7360 × 4630 mm
Bedroom
3050 × 3720 mm
Terrace Area
21.4 sq m / 230 sq ft



C.C.01.07 STUDIO

Internal Area
35.9 sq m / 386 sq ft
Living Area
4950 × 3760 mm
Bedroom
2945 × 2845 mm

C.C.01.08 TWO BEDROOM

Internal Area
75.4 sq m / 812 sq ft
Living Area
7355 × 3900 mm
Bedroom 1
3645 × 3020 mm
Bedroom 2
2655 × 3580 mm
Balcony Area
5.1 sq m / 55 sq ft

C.C.01.09 ONE BEDROOM

Internal Area
50.1 sq m / 539 sq ft
Living Area
6480 × 4025 mm
Bedroom
3050 × 3590 mm
Balcony Area
6.1 sq m / 66 sq ft

C.C.01.01 ONE BEDROOM

Internal Area
56.8 sq m / 611 sq ft
Living Area
7360 × 4630 mm
Bedroom
3050 × 3670 mm
Balcony Area
6.1 sq m / 66 sq ft

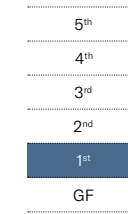

LEGEND

- L Laundry
- U Utility Cupboard
- F Fridge
- W Wardrobe
- B Balcony
- T Terrace

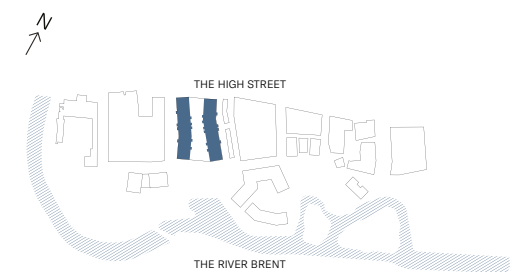

Disclaimer

This brochure and the information contained in it does not form part of any contract, and while reasonable effort has been made to ensure accuracy, this cannot be guaranteed and no representation or warranty is made in that regard. Apartment designs and layouts are indicative only and may change. The specification of the apartments is the anticipated specification as at the date this brochure was prepared, but may be subject to change in accordance with permitted variances under the apartment sale contracts. Dimensions shown in any text or plan are approximate sizes only and actual sizes may be different once constructed (although it is not anticipated that any apartments will be reduced by more than 5% in size). Computer generated images and photos are indicative only. All sales remain subject to contract. All information regarding prospective commercial or retail tenants represents current intention only, and the final identity of the tenants may change. Furniture shown in computer generated images and photos is not included in sales. The Brentford Project is a marketing name only and will not necessarily form part of the approved postal address. Neither the agents nor any person in their employ has any authority to make or give any representation warranty or guarantee (whether written or oral) in respect of or in relation to the development (or any parts thereof). Any dates quoted (including but not limited to completion dates) are estimates only based on current projected development programme and therefore are subject to change. Details of facilities for the development referred to herein are those which are currently anticipated but the developer reserves the right to alter those facilities at its discretion and without notice. In addition where facilities are being provided, they may not be available for use at the time that any given flat sale is due to complete. In addition certain facilities will be located in phase 2 and as such will not be available until the development of phase 2 has been completed.

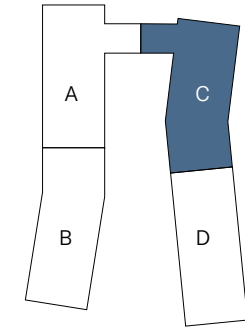

C.C.02.06 ONE BEDROOM
Internal Area
 61.2 sq m / 659 sq ft
Living Area
 5920 × 6550 mm
Bedroom
 3475 × 3065 mm



C.C.02.07 STUDIO
Internal Area
 35.9 sq m / 386 sq ft
Living Area
 4950 × 3760 mm
Bedroom
 2945 × 2845 mm



C.C.02.05 ONE BEDROOM
Internal Area
 56.4 sq m / 607 sq ft
Living Area
 6480 × 4880 mm
Bedroom
 3050 × 3720 mm



C.C.02.08 TWO BEDROOM
Internal Area
 75.4 sq m / 812 sq ft
Living Area
 7355 × 3900 mm
Bedroom 1
 3645 × 3020 mm
Bedroom 2
 2655 × 3580 mm
Balcony Area
 5.7 sq m / 61 sq ft



C.C.02.04 ONE BEDROOM SUITE
Internal Area
 41.5 sq m / 447 sq ft
Living Area
 6485 × 3580 mm
Bedroom
 2885 × 2720 mm
Balcony Area
 5.9 sq m / 63 sq ft



C.C.02.09 ONE BEDROOM
Internal Area
 50.1 sq m / 539 sq ft
Living Area
 6480 × 4025 mm
Bedroom
 3050 × 3590 mm
Balcony Area
 6.1 sq m / 66 sq ft

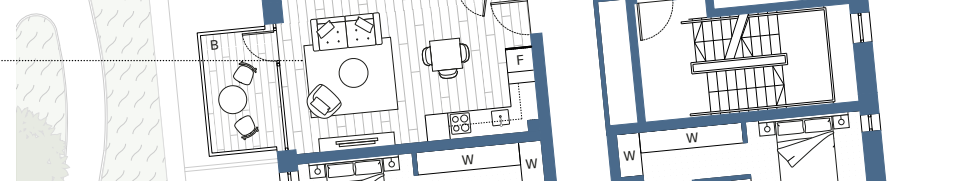

C.C.02.03 ONE BEDROOM SUITE
Internal Area
 45.9 sq m / 494 sq ft
Living Area
 6485 × 5060 mm
Bedroom
 2855 × 2720 mm
Balcony Area
 6.1 sq m / 66 sq ft

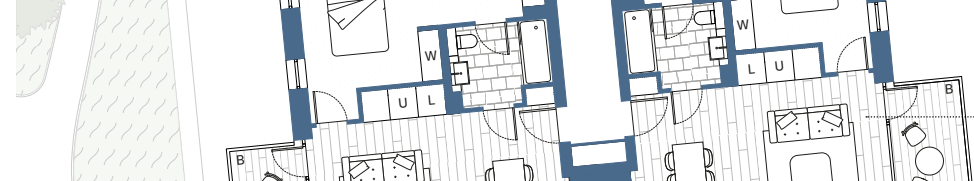

C.C.02.01 ONE BEDROOM
Internal Area
 56.8 sq m / 611 sq ft
Living Area
 7360 × 4630 mm
Bedroom
 3050 × 3670 mm
Balcony Area
 6.1 sq m / 66 sq ft



C.C.02.02 ONE BEDROOM
Internal Area
 57.1 sq m / 615 sq ft
Living Area
 7360 × 4630 mm
Bedroom
 3050 × 3720 mm
Balcony Area
 6.1 sq m / 66 sq ft

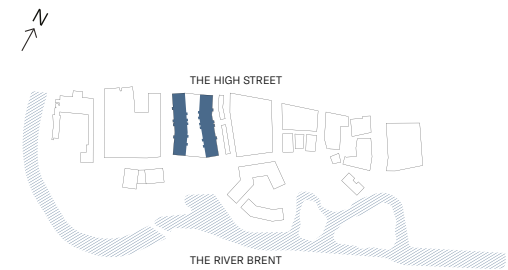
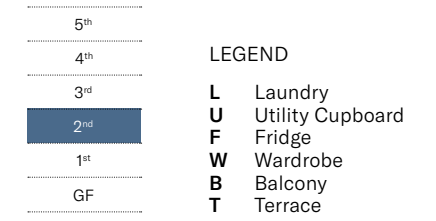

Disclaimer
 This brochure and the information contained in it does not form part of any contract, and while reasonable effort has been made to ensure accuracy, this cannot be guaranteed and no representation or warranty is made in that regard. Apartment designs and layouts are indicative only and may change. The specification of the apartments is the anticipated specification as at the date this brochure was prepared, but may be subject to change in accordance with permitted variances under the apartment sale contracts. Dimensions shown in any text or plan are approximate sizes only and actual sizes may be different once constructed (although it is not anticipated that any apartments will be reduced by more than 5% in size). Computer generated images and photos are indicative only. All sales remain subject to contract. All information regarding prospective commercial or retail tenants represents current intention only, and the final identity of the tenants may change. Furniture shown in computer generated images and photos is not included in sales. The Brentford Project is a marketing name only and will not necessarily form part of the approved postal address. Neither the agents nor any person in their employ has any authority to make or give any representation warranty or guarantee (whether written or oral) in respect of or in relation to the development (or any parts thereof). Any dates quoted (including but not limited to completion dates) are estimates only based on current projected development programme and therefore are subject to change. Details of facilities for the development referred to herein are those which are currently anticipated but the developer reserves the right to alter those facilities at its discretion and without notice. In addition where facilities are being provided, they may not be available for use at the time that any given flat sale is due to complete. In addition certain facilities will be located in phase 2 and as such will not be available until the development of phase 2 has been completed.

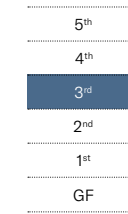
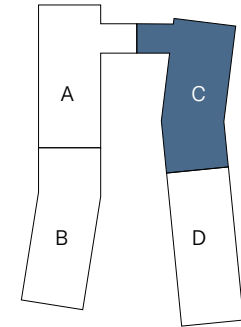

LEGEND

L	Laundry
U	Utility Cupboard
F	Fridge
W	Wardrobe
B	Balcony
T	Terrace

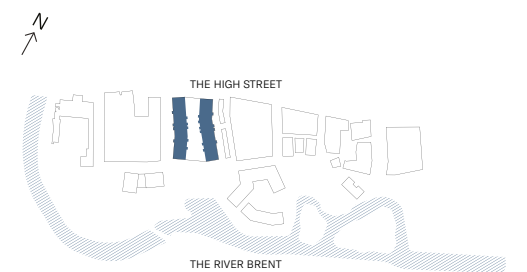

Disclaimer

This brochure and the information contained in it does not form part of any contract, and while reasonable effort has been made to ensure accuracy, this cannot be guaranteed and no representation or warranty is made in that regard. Apartment designs and layouts are indicative only and may change. The specification of the apartments is the anticipated specification as at the date this brochure was prepared, but may be subject to change in accordance with permitted variances under the apartment sale contracts. Dimensions shown in any text or plan are approximate sizes only and actual sizes may be different once constructed (although it is not anticipated that any apartments will be reduced by more than 5% in size). Computer generated images and photos are indicative only. All sales remain subject to contract. All information regarding prospective commercial or retail tenants represents current intention only, and the final identity of the tenants may change. Furniture shown in computer generated images and photos is not included in sales. The Brentford Project is a marketing name only and will not necessarily form part of the approved postal address. Neither the agents nor any person in their employ has any authority to make or give any representation warranty or guarantee (whether written or oral) in respect of or in relation to the development (or any parts thereof). Any dates quoted (including but not limited to completion dates) are estimates only based on current projected development programme and therefore are subject to change. Details of facilities for the development referred to herein are those which are currently anticipated but the developer reserves the right to alter those facilities at its discretion and without notice. In addition where facilities are being provided, they may not be available for use at the time that any given flat sale is due to complete. In addition certain facilities will be located in phase 2 and as such will not be available until the development of phase 2 has been completed.

C.C.03.05 THREE BEDROOM

Internal Area
107.4 sq m / 1156 sq ft
Living Area
7810 × 5400 mm
Bedroom 1
4150 × 3020 mm
Bedroom 2
2900 × 3580 mm
Bedroom 3
2900 × 3580 mm

C.C.03.06 TWO BEDROOM

Internal Area
73.5 sq m / 791 sq ft
Living Area
6905 × 3900 mm
Bedroom 1
3645 × 3025 mm
Bedroom 2
2655 × 3580 mm
Balcony Area
5.1 sq m / 55 sq ft

C.C.03.04 ONE BEDROOM SUITE

Internal Area
41.5 sq m / 447 sq ft
Living Area
6485 × 3580 mm
Bedroom
2885 × 2720 mm
Balcony Area
5.9 sq m / 63 sq ft

C.C.03.07 ONE BEDROOM

Internal Area
50.1 sq m / 539 sq ft
Living Area
6480 × 4025 mm
Bedroom
3050 × 3590 mm
Balcony Area
6.1 sq m / 66 sq ft

C.C.03.03 ONE BEDROOM SUITE

Internal Area
45.9 sq m / 494 sq ft
Living Area
6485 × 5060 mm
Bedroom
2855 × 2720 mm
Balcony Area
6.1 sq m / 66 sq ft

C.C.03.01 ONE BEDROOM

Internal Area
56.8 sq m / 611 sq ft
Living Area
7360 × 4630 mm
Bedroom
3050 × 3670 mm
Balcony Area
6.1 sq m / 66 sq ft

C.C.03.02 ONE BEDROOM

Internal Area
57.1 sq m / 615 sq ft
Living Area
7360 × 4630 mm
Bedroom
3050 × 3720 mm
Balcony Area
6.1 sq m / 66 sq ft

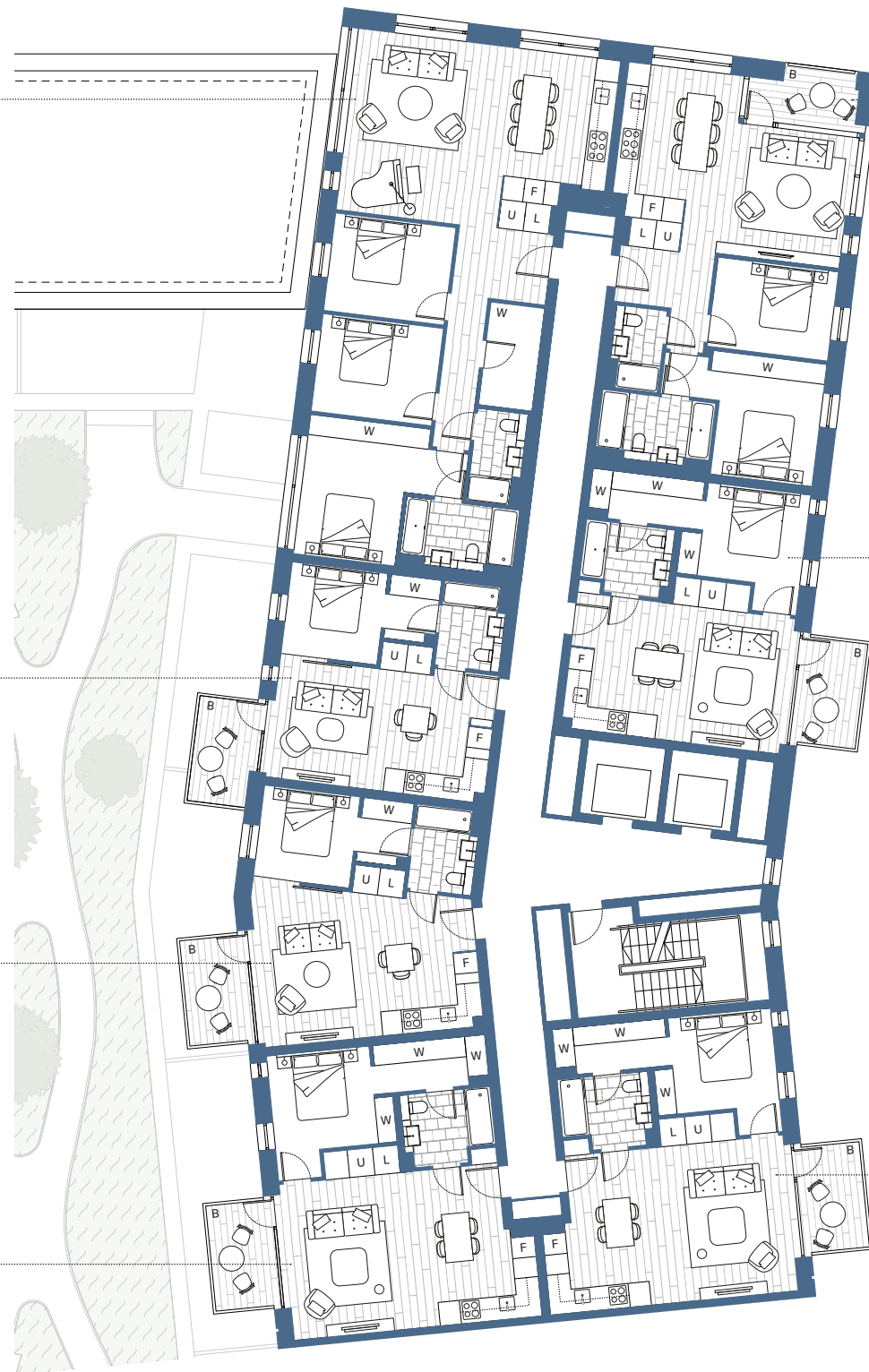

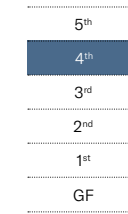
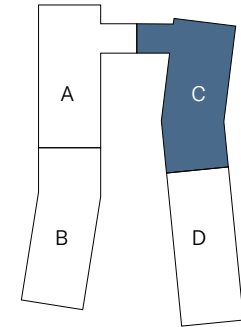

- LEGEND**
- L Laundry
 - U Utility Cupboard
 - F Fridge
 - W Wardrobe
 - B Balcony
 - T Terrace

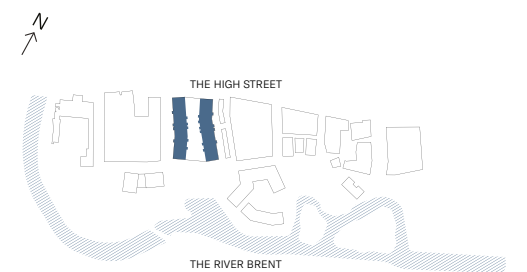

C.C.04.05 THREE BEDROOM

Internal Area
102.9 sq m / 1108 sq ft

Living Area
6910 × 5400 mm

Bedroom 1
4150 × 3030 mm

Bedroom 2
2900 × 3580 mm

Bedroom 3
2900 × 3580 mm

C.C.04.06 TWO BEDROOM

Internal Area
77.4 sq m / 833 sq ft

Living Area
7810 × 3900 mm

Bedroom 1
3645 × 3025 mm

Bedroom 2
2655 × 3580 mm

Balcony Area
5.7 sq m / 61 sq ft

C.C.04.04 ONE BEDROOM SUITE

Internal Area
41.5 sq m / 447 sq ft

Living Area
6485 × 3580 mm

Bedroom
2885 × 2720 mm

Balcony Area
5.9 sq m / 63 sq ft

C.C.04.07 ONE BEDROOM

Internal Area
50.1 sq m / 539 sq ft

Living Area
6480 × 4025 mm

Bedroom
3050 × 3590 mm

Balcony Area
6.1 sq m / 66 sq ft

C.C.04.03 ONE BEDROOM SUITE

Internal Area
46.0 sq m / 495 sq ft

Living Area
6485 × 5060 mm

Bedroom
2855 × 2720 mm

Balcony Area
6.1 sq m / 66 sq ft

C.C.04.01 ONE BEDROOM

Internal Area
56.8 sq m / 611 sq ft

Living Area
7360 × 4630 mm

Bedroom
3050 × 3670 mm

Balcony Area
6.1 sq m / 66 sq ft

C.C.04.02 ONE BEDROOM

Internal Area
57.1 sq m / 615 sq ft

Living Area
7360 × 4630 mm

Bedroom
3050 × 3720 mm

Balcony Area
6.1 sq m / 66 sq ft

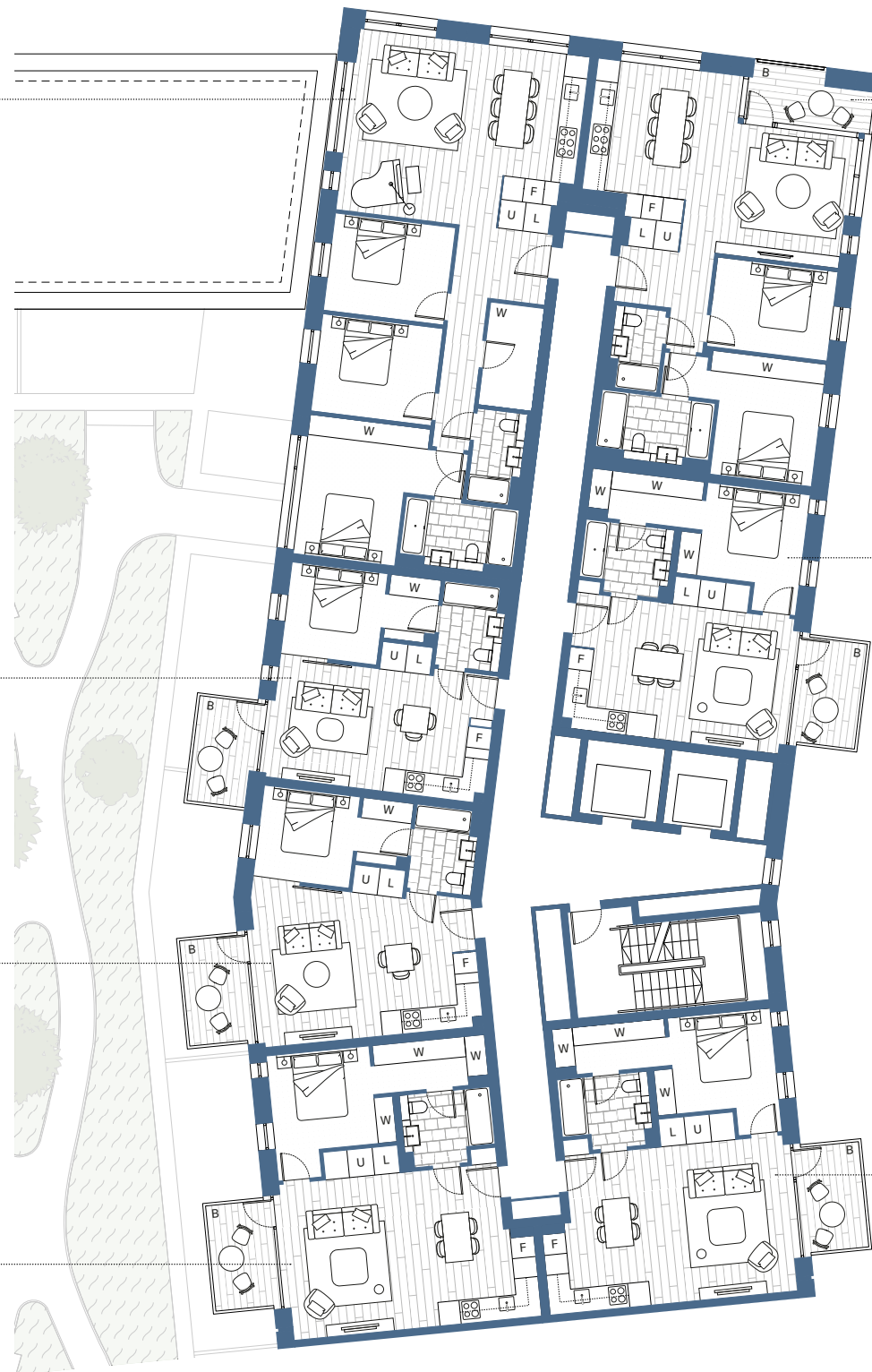

Disclaimer

This brochure and the information contained in it does not form part of any contract, and while reasonable effort has been made to ensure accuracy, this cannot be guaranteed and no representation or warranty is made in that regard. Apartment designs and layouts are indicative only and may change. The specification of the apartments is the anticipated specification as at the date this brochure was prepared, but may be subject to change in accordance with permitted variances under the apartment sale contracts. Dimensions shown in any text or plan are approximate sizes only and actual sizes may be different once constructed (although it is not anticipated that any apartments will be reduced by more than 5% in size). Computer generated images and photos are indicative only. All sales remain subject to contract. All information regarding prospective commercial or retail tenants represents current intention only, and the final identity of the tenants may change. Furniture shown in computer generated images and photos is not included in sales. The Brentford Project is a marketing name only and will not necessarily form part of the approved postal address. Neither the agents nor any person in their employ has any authority to make or give any representation warranty or guarantee (whether written or oral) in respect of or in relation to the development (or any parts thereof). Any dates quoted (including but not limited to completion dates) are estimates only based on current projected development programme and therefore are subject to change. Details of facilities for the development referred to herein are those which are currently anticipated but the developer reserves the right to alter those facilities at its discretion and without notice. In addition where facilities are being provided, they may not be available for use at the time that any given flat sale is due to complete. In addition certain facilities will be located in phase 2 and as such will not be available until the development of phase 2 has been completed.

Willow

Level 05 Core C

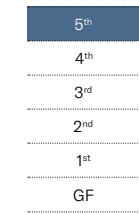
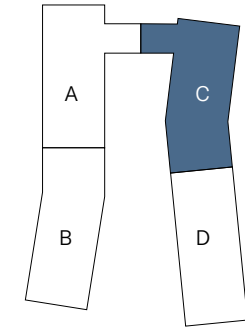

LEGEND

L	Laundry
U	Utility Cupboard
F	Fridge
W	Wardrobe
B	Balcony
T	Terrace

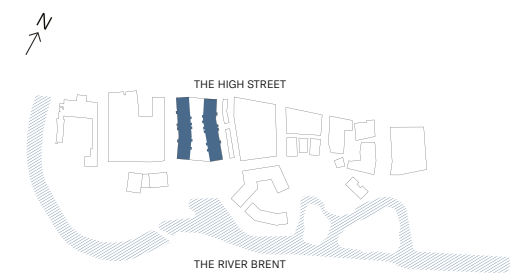

Disclaimer

This brochure and the information contained in it does not form part of any contract, and while reasonable effort has been made to ensure accuracy, this cannot be guaranteed and no representation or warranty is made in that regard. Apartment designs and layouts are indicative only and may change. The specification of the apartments is the anticipated specification as at the date this brochure was prepared, but may be subject to change in accordance with permitted variances under the apartment sale contracts. Dimensions shown in any text or plan are approximate sizes only and actual sizes may be different once constructed (although it is not anticipated that any apartments will be reduced by more than 5% in size). Computer generated images and photos are indicative only. All sales remain subject to contract. All information regarding prospective commercial or retail tenants represents current intention only, and the final identity of the tenants may change. Furniture shown in computer generated images and photos is not included in sales. The Brentford Project is a marketing name only and will not necessarily form part of the approved postal address. Neither the agents nor any person in their employ has any authority to make or give any representation warranty or guarantee (whether written or oral) in respect of or in relation to the development (or any parts thereof). Any dates quoted (including but not limited to completion dates) are estimates only based on current projected development programme and therefore are subject to change. Details of facilities for the development referred to herein are those which are currently anticipated but the developer reserves the right to alter those facilities at its discretion and without notice. In addition where facilities are being provided, they may not be available for use at the time that any given flat sale is due to complete. In addition certain facilities will be located in phase 2 and as such will not be available until the development of phase 2 has been completed.

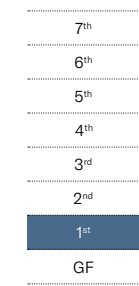
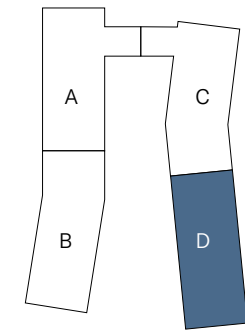

LEGEND

- L Laundry
- U Utility Cupboard
- F Fridge
- W Wardrobe
- B Balcony
- T Terrace

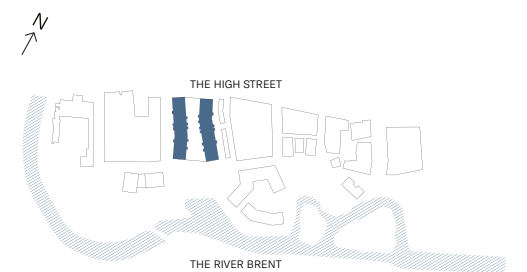

C.D.01.05 TWO BEDROOM

Internal Area
78.6 sq m / 846 sq ft
Living Area
7360 x 4450 mm
Bedroom 1
3645 x 3025 mm
Bedroom 2
3255 x 3580 mm
Terrace Area
28.3 sq m / 305 sq ft

C.D.01.06 TWO BEDROOM

Internal Area
78.6 sq m / 846 sq ft
Living Area
7360 x 4450 mm
Bedroom 1
3645 x 3025 mm
Bedroom 2
3255 x 3580 mm
Balcony Area
6.1 sq m / 66 sq ft

C.D.01.04 ONE BEDROOM SUITE

Internal Area
44.9 sq m / 483 sq ft
Living Area
6485 x 3995 mm
Bedroom
2880 x 2825 mm
Terrace Area
16.9 sq m / 182 sq ft

C.D.01.07 ONE BEDROOM

Internal Area
50.4 sq m / 543 sq ft
Living Area
6480 x 4055 mm
Bedroom
3050 x 3620 mm
Balcony Area
6.1 sq m / 66 sq ft

C.D.01.03 ONE BEDROOM SUITE

Internal Area
41.5 sq m / 447 sq ft
Living Area
6485 x 3580 mm
Bedroom
2850 x 2720 mm
Terrace Area
16.4 sq m / 176 sq ft

C.D.01.01 TWO BEDROOM

Internal Area
76.4 sq m / 822 sq ft
Living Area
7805 x 3900 mm
Bedroom 1
3590 x 3025 mm
Bedroom 2
2655 x 3580 mm
Balcony Area
5.7 sq m / 61 sq ft

C.D.01.02 TWO BEDROOM

Internal Area
73.3 sq m / 789 sq ft
Living Area
6905 x 3905 mm
Bedroom 1
3645 x 3025 mm
Bedroom 2
2655 x 3580 mm
Balcony & Terrace Area
22.9 sq m / 247 sq ft



Disclaimer

This brochure and the information contained in it does not form part of any contract, and while reasonable effort has been made to ensure accuracy, this cannot be guaranteed and no representation or warranty is made in that regard. Apartment designs and layouts are indicative only and may change. The specification of the apartments is the anticipated specification as at the date this brochure was prepared, but may be subject to change in accordance with permitted variances under the apartment sale contracts. Dimensions shown in any text or plan are approximate sizes only and actual sizes may be different once constructed (although it is not anticipated that any apartments will be reduced by more than 5% in size). Computer generated images and photos are indicative only. All sales remain subject to contract. All information regarding prospective commercial or retail tenants represents current intention only, and the final identity of the tenants may change. Furniture shown in computer generated images and photos is not included in sales. The Brentford Project is a marketing name only and will not necessarily form part of the approved postal address. Neither the agents nor any person in their employ has any authority to make or give any representation warranty or guarantee (whether written or oral) in respect of or in relation to the development (or any parts thereof). Any dates quoted (including but not limited to completion dates) are estimates only based on current projected development programme and therefore are subject to change. Details of facilities for the development referred to herein are those which are currently anticipated but the developer reserves the right to alter those facilities at its discretion and without notice. In addition where facilities are being provided, they may not be available for use at the time that any given flat sale is due to complete. In addition certain facilities will be located in phase 2 and as such will not be available until the development of phase 2 has been completed.

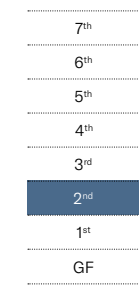
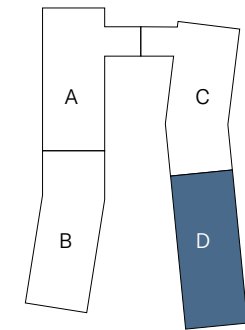

LEGEND

- L Laundry
- U Utility Cupboard
- F Fridge
- W Wardrobe
- B Balcony
- T Terrace

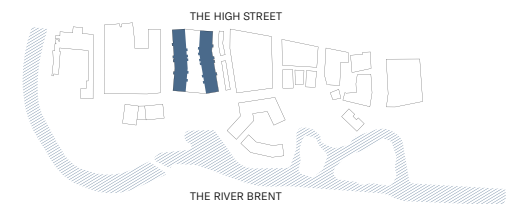

C.D.02.05 TWO BEDROOM

Internal Area
78.6 sq m / 846 sq ft
Living Area
7360 x 4450 mm
Bedroom 1
3645 x 3025 mm
Bedroom 2
3255 x 3580 mm
Balcony Area
6.1 sq m / 66 sq ft

C.D.02.06 TWO BEDROOM

Internal Area
78.6 sq m / 846 sq ft
Living Area
7360 x 4450 mm
Bedroom 1
3645 x 3025 mm
Bedroom 2
3255 x 3580 mm
Balcony Area
6.1 sq m / 66 sq ft

C.D.02.04 ONE BEDROOM

Internal Area
56.2 sq m / 605 sq ft
Living Area
6485 x 4880 mm
Bedroom
3720 x 3050 mm
Balcony Area
5.9 sq m / 64 sq ft

C.D.02.07 ONE BEDROOM

Internal Area
50.4 sq m / 543 sq ft
Living Area
6480 x 4055 mm
Bedroom
3050 x 3620 mm
Balcony Area
6.1 sq m / 66 sq ft

C.D.02.03 ONE BEDROOM SUITE

Internal Area
41.5 sq m / 447 sq ft
Living Area
6485 x 3580 mm
Bedroom
2850 x 2720 mm
Balcony Area
6.1 sq m / 66 sq ft

C.D.02.01 TWO BEDROOM

Internal Area
72.9 sq m / 785 sq ft
Living Area
6905 x 3905 mm
Bedroom 1
3590 x 3025 mm
Bedroom 2
2655 x 3580 mm
Balcony Area
5.1 sq m / 55 sq ft

C.D.02.02 TWO BEDROOM

Internal Area
76.7 sq m / 826 sq ft
Living Area
7805 x 3900 mm
Bedroom 1
3645 x 3025 mm
Bedroom 2
2655 x 3580 mm
Balcony Area
5.7 sq m / 61 sq ft



Disclaimer

This brochure and the information contained in it does not form part of any contract, and while reasonable effort has been made to ensure accuracy, this cannot be guaranteed and no representation or warranty is made in that regard. Apartment designs and layouts are indicative only and may change. The specification of the apartments is the anticipated specification as at the date this brochure was prepared, but may be subject to change in accordance with permitted variances under the apartment sale contracts. Dimensions shown in any text or plan are approximate sizes only and actual sizes may be different once constructed (although it is not anticipated that any apartments will be reduced by more than 5% in size). Computer generated images and photos are indicative only. All sales remain subject to contract. All information regarding prospective commercial or retail tenants represents current intention only, and the final identity of the tenants may change. Furniture shown in computer generated images and photos is not included in sales. The Brentford Project is a marketing name only and will not necessarily form part of the approved postal address. Neither the agents nor any person in their employ has any authority to make or give any representation warranty or guarantee (whether written or oral) in respect of or in relation to the development (or any parts thereof). Any dates quoted (including but not limited to completion dates) are estimates only based on current projected development programme and therefore are subject to change. Details of facilities for the development referred to herein are those which are currently anticipated but the developer reserves the right to alter those facilities at its discretion and without notice. In addition where facilities are being provided, they may not be available for use at the time that any given flat sale is due to complete. In addition certain facilities will be located in phase 2 and as such will not be available until the development of phase 2 has been completed.

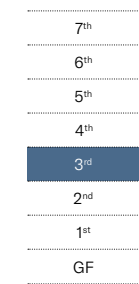
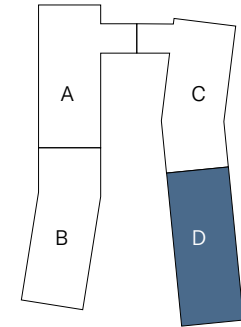

LEGEND

- L Laundry
- U Utility Cupboard
- F Fridge
- W Wardrobe
- B Balcony
- T Terrace

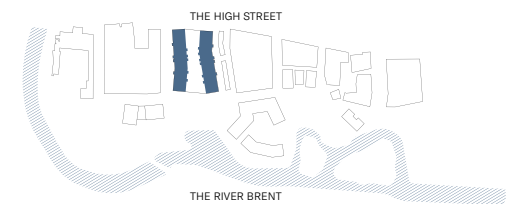

C.D.03.05 TWO BEDROOM

Internal Area
78.6 sq m / 846 sq ft
Living Area
7360 x 4450 mm
Bedroom 1
3645 x 3025 mm
Bedroom 2
3255 x 3580 mm
Balcony Area
6.1 sq m / 66 sq ft

C.D.03.06 TWO BEDROOM

Internal Area
78.6 sq m / 846 sq ft
Living Area
7360 x 4450 mm
Bedroom 1
3645 x 3025 mm
Bedroom 2
3255 x 3580 mm
Balcony Area
6.1 sq m / 66 sq ft

C.D.03.04 ONE BEDROOM

Internal Area
56.2 sq m / 605 sq ft
Living Area
6485 x 4880 mm
Bedroom
3720 x 3050 mm
Balcony Area
5.9 sq m / 64 sq ft

C.D.03.07 ONE BEDROOM

Internal Area
50.4 sq m / 543 sq ft
Living Area
6480 x 4055 mm
Bedroom
3050 x 3620 mm
Balcony Area
6.1 sq m / 66 sq ft

C.D.03.03 ONE BEDROOM SUITE

Internal Area
41.5 sq m / 447 sq ft
Living Area
6485 x 3580 mm
Bedroom
2850 x 2720 mm
Balcony Area
6.1 sq m / 66 sq ft

C.D.03.01 TWO BEDROOM

Internal Area
76.4 sq m / 822 sq ft
Living Area
7805 x 3900 mm
Bedroom 1
3590 x 3025 mm
Bedroom 2
2655 x 3580 mm
Balcony Area
5.7 sq m / 61 sq ft

C.D.03.02 TWO BEDROOM

Internal Area
73.3 sq m / 789 sq ft
Living Area
6905 x 3905 mm
Bedroom 1
3645 x 3025 mm
Bedroom 2
2655 x 3580 mm
Balcony Area
5.1 sq m / 55 sq ft



Disclaimer

This brochure and the information contained in it does not form part of any contract, and while reasonable effort has been made to ensure accuracy, this cannot be guaranteed and no representation or warranty is made in that regard. Apartment designs and layouts are indicative only and may change. The specification of the apartments is the anticipated specification as at the date this brochure was prepared, but may be subject to change in accordance with permitted variances under the apartment sale contracts. Dimensions shown in any text or plan are approximate sizes only and actual sizes may be different once constructed (although it is not anticipated that any apartments will be reduced by more than 5% in size). Computer generated images and photos are indicative only. All sales remain subject to contract. All information regarding prospective commercial or retail tenants represents current intention only, and the final identity of the tenants may change. Furniture shown in computer generated images and photos is not included in sales. The Brentford Project is a marketing name only and will not necessarily form part of the approved postal address. Neither the agents nor any person in their employ has any authority to make or give any representation warranty or guarantee (whether written or oral) in respect of or in relation to the development (or any parts thereof). Any dates quoted (including but not limited to completion dates) are estimates only based on current projected development programme and therefore are subject to change. Details of facilities for the development referred to herein are those which are currently anticipated but the developer reserves the right to alter those facilities at its discretion and without notice. In addition where facilities are being provided, they may not be available for use at the time that any given flat sale is due to complete. In addition certain facilities will be located in phase 2 and as such will not be available until the development of phase 2 has been completed.

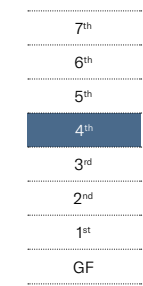
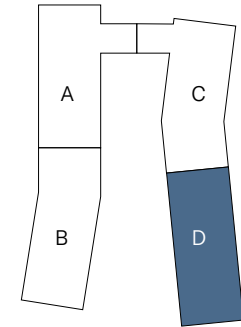

LEGEND

- L Laundry
- U Utility Cupboard
- F Fridge
- W Wardrobe
- B Balcony
- T Terrace

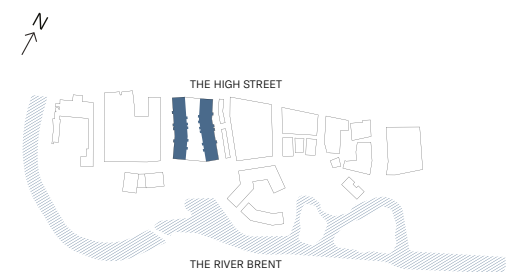

C.D.04.05 TWO BEDROOM

Internal Area
78.6 sq m / 846 sq ft
Living Area
7360 x 4450 mm
Bedroom 1
3645 x 3025 mm
Bedroom 2
3255 x 3580 mm
Balcony Area
6.1 sq m / 66 sq ft

C.D.04.06 TWO BEDROOM

Internal Area
78.6 sq m / 846 sq ft
Living Area
7360 x 4450 mm
Bedroom 1
3645 x 3025 mm
Bedroom 2
3255 x 3580 mm
Balcony Area
6.1 sq m / 66 sq ft

C.D.04.04 ONE BEDROOM

Internal Area
56.2 sq m / 605 sq ft
Living Area
6485 x 4880 mm
Bedroom
3720 x 3050 mm
Balcony Area
5.9 sq m / 64 sq ft

C.D.04.07 ONE BEDROOM

Internal Area
50.4 sq m / 543 sq ft
Living Area
6480 x 4055 mm
Bedroom
3050 x 3620 mm
Balcony Area
6.1 sq m / 66 sq ft

C.D.04.03 ONE BEDROOM SUITE

Internal Area
41.5 sq m / 447 sq ft
Living Area
6485 x 3580 mm
Bedroom
2850 x 2720 mm
Balcony Area
6.1 sq m / 66 sq ft

C.D.04.01 TWO BEDROOM

Internal Area
72.9 sq m / 785 sq ft
Living Area
6905 x 3905 mm
Bedroom 1
3590 x 3025 mm
Bedroom 2
2655 x 3580 mm
Balcony Area
5.1 sq m / 55 sq ft

C.D.04.02 TWO BEDROOM

Internal Area
76.7 sq m / 826 sq ft
Living Area
7805 x 3900 mm
Bedroom 1
3645 x 3025 mm
Bedroom 2
2655 x 3580 mm
Balcony Area
5.7 sq m / 61 sq ft



Disclaimer

This brochure and the information contained in it does not form part of any contract, and while reasonable effort has been made to ensure accuracy, this cannot be guaranteed and no representation or warranty is made in that regard. Apartment designs and layouts are indicative only and may change. The specification of the apartments is the anticipated specification as at the date this brochure was prepared, but may be subject to change in accordance with permitted variances under the apartment sale contracts. Dimensions shown in any text or plan are approximate sizes only and actual sizes may be different once constructed (although it is not anticipated that any apartments will be reduced by more than 5% in size). Computer generated images and photos are indicative only. All sales remain subject to contract. All information regarding prospective commercial or retail tenants represents current intention only, and the final identity of the tenants may change. Furniture shown in computer generated images and photos is not included in sales. The Brentford Project is a marketing name only and will not necessarily form part of the approved postal address. Neither the agents nor any person in their employ has any authority to make or give any representation warranty or guarantee (whether written or oral) in respect of or in relation to the development (or any parts thereof). Any dates quoted (including but not limited to completion dates) are estimates only based on current projected development programme and therefore are subject to change. Details of facilities for the development referred to herein are those which are currently anticipated but the developer reserves the right to alter those facilities at its discretion and without notice. In addition where facilities are being provided, they may not be available for use at the time that any given flat sale is due to complete. In addition certain facilities will be located in phase 2 and as such will not be available until the development of phase 2 has been completed.

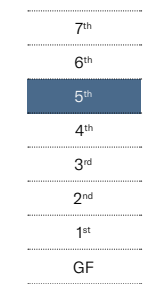
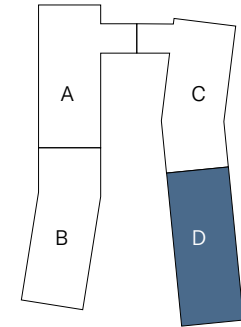

LEGEND

- L Laundry
- U Utility Cupboard
- F Fridge
- W Wardrobe
- B Balcony
- T Terrace

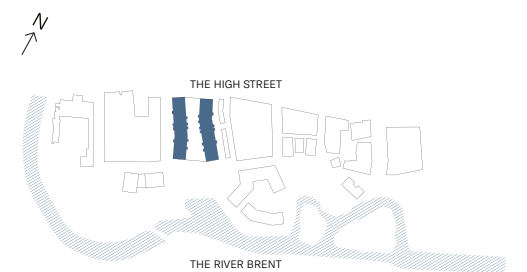

C.D.05.05 TWO BEDROOM

Internal Area
80.4 sq m / 865 sq ft
Living Area
7810 × 4440 mm
Bedroom 1
3645 × 3025 mm
Bedroom 2
3255 × 3580 mm
Balcony Area
6.1 sq m / 66 sq ft

C.D.05.06 TWO BEDROOM

Internal Area
76.6 sq m / 825 sq ft
Living Area
6910 × 4440 mm
Bedroom 1
3645 × 3025 mm
Bedroom 2
3255 × 3580 mm
Balcony Area
6.1 sq m / 66 sq ft

C.D.05.04 ONE BEDROOM

Internal Area
56.2 sq m / 605 sq ft
Living Area
6485 × 4880 mm
Bedroom
3720 × 3050 mm
Balcony Area
5.9 sq m / 64 sq ft

C.D.05.07 ONE BEDROOM

Internal Area
50.4 sq m / 543 sq ft
Living Area
6480 × 4055 mm
Bedroom
3050 × 3620 mm
Balcony Area
6.1 sq m / 66 sq ft

C.D.05.03 ONE BEDROOM SUITE

Internal Area
41.5 sq m / 447 sq ft
Living Area
6485 × 3580 mm
Bedroom
2850 × 2720 mm
Balcony Area
6.1 sq m / 66 sq ft

C.D.05.01 TWO BEDROOM

Internal Area
76.4 sq m / 822 sq ft
Living Area
7805 × 3900 mm
Bedroom 1
3590 × 3025 mm
Bedroom 2
2655 × 3580 mm
Balcony Area
5.7 sq m / 61 sq ft

C.D.05.02 TWO BEDROOM

Internal Area
73.3 sq m / 789 sq ft
Living Area
6905 × 3905 mm
Bedroom 1
3645 × 3025 mm
Bedroom 2
2655 × 3580 mm
Balcony Area
5.1 sq m / 55 sq ft



Disclaimer

This brochure and the information contained in it does not form part of any contract, and while reasonable effort has been made to ensure accuracy, this cannot be guaranteed and no representation or warranty is made in that regard. Apartment designs and layouts are indicative only and may change. The specification of the apartments is the anticipated specification as at the date this brochure was prepared, but may be subject to change in accordance with permitted variances under the apartment sale contracts. Dimensions shown in any text or plan are approximate sizes only and actual sizes may be different once constructed (although it is not anticipated that any apartments will be reduced by more than 5% in size). Computer generated images and photos are indicative only. All sales remain subject to contract. All information regarding prospective commercial or retail tenants represents current intention only, and the final identity of the tenants may change. Furniture shown in computer generated images and photos is not included in sales. The Brentford Project is a marketing name only and will not necessarily form part of the approved postal address. Neither the agents nor any person in their employ has any authority to make or give any representation warranty or guarantee (whether written or oral) in respect of or in relation to the development (or any parts thereof). Any dates quoted (including but not limited to completion dates) are estimates only based on current projected development programme and therefore are subject to change. Details of facilities for the development referred to herein are those which are currently anticipated but the developer reserves the right to alter those facilities at its discretion and without notice. In addition where facilities are being provided, they may not be available for use at the time that any given flat sale is due to complete. In addition certain facilities will be located in phase 2 and as such will not be available until the development of phase 2 has been completed.

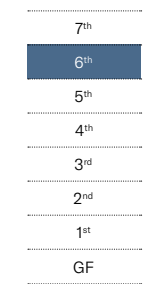
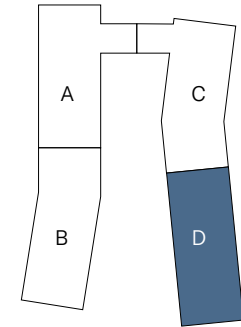

LEGEND

- L** Laundry
- U** Utility Cupboard
- F** Fridge
- W** Wardrobe
- B** Balcony
- T** Terrace

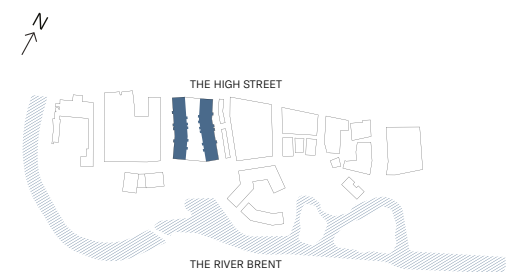

Disclaimer

This brochure and the information contained in it does not form part of any contract, and while reasonable effort has been made to ensure accuracy, this cannot be guaranteed and no representation or warranty is made in that regard. Apartment designs and layouts are indicative only and may change. The specification of the apartments is the anticipated specification as at the date this brochure was prepared, but may be subject to change in accordance with permitted variances under the apartment sale contracts. Dimensions shown in any text or plan are approximate sizes only and actual sizes may be different once constructed (although it is not anticipated that any apartments will be reduced by more than 5% in size). Computer generated images and photos are indicative only. All sales remain subject to contract. All information regarding prospective commercial or retail tenants represents current intention only, and the final identity of the tenants may change. Furniture shown in computer generated images and photos is not included in sales. The Brentford Project is a marketing name only and will not necessarily form part of the approved postal address. Neither the agents nor any person in their employ has any authority to make or give any representation warranty or guarantee (whether written or oral) in respect of or in relation to the development (or any parts thereof). Any dates quoted (including but not limited to completion dates) are estimates only based on current projected development programme and therefore are subject to change. Details of facilities for the development referred to herein are those which are currently anticipated but the developer reserves the right to alter those facilities at its discretion and without notice. In addition where facilities are being provided, they may not be available for use at the time that any given flat sale is due to complete. In addition certain facilities will be located in phase 2 and as such will not be available until the development of phase 2 has been completed.

C.D.06.04 THREE BEDROOM

Internal Area
132.7 sq m / 1428 sq ft
Living Area
6910 × 6065 mm
Bedroom 1
3705 × 3025 mm
Bedroom 2
3050 × 3580 mm
Bedroom 3
3325 × 3580 mm
Balcony & Terrace Area
89.0 sq m / 958 sq ft

C.D.06.05 TWO BEDROOM

Internal Area
80.4 sq m / 865 sq ft
Living Area
7810 × 4440 mm
Bedroom 1
3645 × 3025 mm
Bedroom 2
3255 × 3580 mm
Balcony Area
6.1 sq m / 66 sq ft

C.D.06.06 ONE BEDROOM

Internal Area
50.4 sq m / 543 sq ft
Living Area
6480 × 4055 mm
Bedroom
3620 × 3050 mm
Balcony Area
6.1 sq m / 66 sq ft

C.D.06.03 ONE BEDROOM SUITE

Internal Area
41.5 sq m / 447 sq ft
Living Area
6485 × 3580 mm
Bedroom
2885 × 2720 mm
Balcony Area
5.9 sq m / 64 sq ft

C.D.06.01 TWO BEDROOM

Internal Area
72.9 sq m / 785 sq ft
Living Area
6905 × 3905 mm
Bedroom 1
3590 × 3025 mm
Bedroom 2
2655 × 3580 mm
Balcony Area
5.1 sq m / 55 sq ft

C.D.06.02 THREE BEDROOM

Internal Area
127.2 sq m / 1369 sq ft
Living Area
7810 × 4005 mm
Bedroom 1
4330 × 3025 mm
Bedroom 2
2900 × 3580 mm
Bedroom 3
2900 × 3580 mm
Balcony & Terrace Area
94.8 sq m / 1020 sq ft



Willow

Level 07 Core D

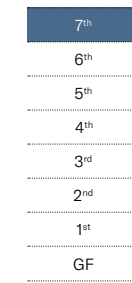
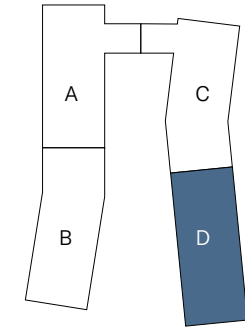

LEGEND

L	Laundry
U	Utility Cupboard
F	Fridge
W	Wardrobe
B	Balcony
T	Terrace

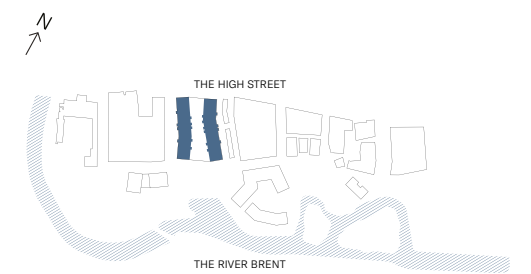

C.D.06.04 THREE BEDROOM

Internal Area
132.7 sq m / 1428 sq ft
Balcony & Terrace Area
89.0 sq m / 958 sq ft

C.D.06.02 THREE BEDROOM

Internal Area
127.2 sq m / 1369 sq ft
Balcony & Terrace Area
94.8 sq m / 1020 sq ft



Disclaimer

This brochure and the information contained in it does not form part of any contract, and while reasonable effort has been made to ensure accuracy, this cannot be guaranteed and no representation or warranty is made in that regard. Apartment designs and layouts are indicative only and may change. The specification of the apartments is the anticipated specification as at the date this brochure was prepared, but may be subject to change in accordance with permitted variances under the apartment sale contracts. Dimensions shown in any text or plan are approximate sizes only and actual sizes may be different once constructed (although it is not anticipated that any apartments will be reduced by more than 5% in size). Computer generated images and photos are indicative only. All sales remain subject to contract. All information regarding prospective commercial or retail tenants represents current intention only, and the final identity of the tenants may change. Furniture shown in computer generated images and photos is not included in sales. The Brentford Project is a marketing name only and will not necessarily form part of the approved postal address. Neither the agents nor any person in their employ has any authority to make or give any representation warranty or guarantee (whether written or oral) in respect of or in relation to the development (or any parts thereof). Any dates quoted (including but not limited to completion dates) are estimates only based on current projected development programme and therefore are subject to change. Details of facilities for the development referred to herein are those which are currently anticipated but the developer reserves the right to alter those facilities at its discretion and without notice. In addition where facilities are being provided, they may not be available for use at the time that any given flat sale is due to complete. In addition certain facilities will be located in phase 2 and as such will not be available until the development of phase 2 has been completed.

Specifications

MAIN STRUCTURE

Reinforced concrete or structural frame and/or load bearing masonry on reinforced concrete piled foundations.

BUILDING ENVELOPE

External wall consisting of quality brick finish, metal panelling, pre-cast concrete cladding and aluminium glazing system, dependent on location.

FLOOR

Reinforced concrete slab with appropriate floor finishes (see flooring).

ROOF

High-performance water-proof membrane roofing overlaid with pre-cast paving and/or soft landscaping where applicable.

WINDOW

Double-glazed aluminium windows including opening lights. Double-glazed aluminium doors to balconies and terraces where appropriate.

STAIRS

Pre-cast concrete or metal stairs with steel balustrades in common areas.

WALL

Party walls constructed from metal studwork finished on both sides with sound resistant plasterboard and acoustic insulation between, or structural concrete faced with plasterboard on both sides or load bearing masonry faced with plasterboard on both sides. Internal walls constructed from metal studwork or modern solid timber panels with plasterboard on each side and acoustic insulation where detailed.

BALCONIES

Painted metal balconies constructed with painted steel vertical rails, handrails and metal decking, where applicable.

CEILING

Suspended plasterboard painted with white washable emulsion. Ceiling height approximately 2.55 m in main living areas and bedrooms in Oak (Building B). Ceiling height approx. 2.70 m in main living areas and bedrooms in Willow (Building C) and Brunel (Building K).

FLOORING

Textured European oak engineered floorboards to hall, living area and kitchen. Fitted steel grey carpets to bedrooms. Marble floor tiles to bathrooms, en-suites and shower room floors.

DECORATION

All internal walls painted with white washable emulsion. Skirting and doors and frames painted with a white eggshell paint finish.

KITCHEN

Integrated European appliances comprising of a black Bertazzoni 5 ring range cooker and black extractor range hood to 2 and 3-bedroom apartments. 4 ring range cooker and black extractor range hood to selected studios, 1-bedroom suites and 1-bedroom apartments. Integrated fridge freezer and dishwasher. Combined washing machine/tumble dryer located in separate utility cupboard where appropriate.

Studios, 1-bedroom suites, 1, 2 and 3-bedroom apartments fitted with custom designed kitchen with modular base and wall cabinets with lacquer paint finish and contrasting interior colour. Black metal pull handle with diamond cut pattern to tall cabinets and base cabinets. Concealed LED lighting to underside of overhead cupboards. Cloudburst concrete worktops fitted with undermounted stainless steel sink and contemporary deck mounted matt black tap. Feature timber wall panelling above worktop.

BATHROOMS

Fitted white bath with brushed brass finish mixer with a contemporary wall mounted hand shower in brushed brass finish and glass screen, or a separate white shower tray with thermostatic wall mounted shower in brushed brass finish with glass shower screen, as defined on plans. White ceramic WC with concealed cistern.

White ceramic hand basin, with brushed brass mixer tap. Bespoke wall mounted mirror finished cabinet, natural oak open shelving and recessed LED lighting. Brushed stainless steel wall mounted heated towel rail. Bathroom walls finished in winch artisan ceramic tiles and painted finish where applicable.

SHOWER ROOM & ENSUITE BATHROOMS

Fitted white shower tray with thermostatic wall mounted shower in brushed brass finish with glass shower screen. Where applicable, fitted white bath with brushed brass finished mixer with wall mounted hand shower in brushed brass finish. White ceramic WC with concealed cistern. White ceramic hand basin, with brushed brass mixer tap. Bespoke wall mounted mirror finished cabinet, open shelving and recessed LED lighting. Winch artisan ceramic tiles or painted finish, to walls in en-suite bathrooms and shower rooms, where applicable.

WARDROBE

Integrated wardrobes fitted in master bedroom with custom designed painted feature doors.

HEATING, COOLING & HOT WATER

Individually metered system provides heating via radiators and hot water from the development's central plant. In apartments where cooling is provided, the cooling system will be metered and will serve bedrooms and living rooms. Centralised wet heating system throughout.

ELECTRICS

Energy efficient lighting in kitchen, hall, bathroom, shower room and en-suite, where appropriate. Switch plates and sockets in accordance with IEE regulations. TV/FM and telephone points for broadband internet access in living room and bedroom; communal satellite dish with connection points in living room and master bedroom. (Purchasers are responsible for their own connections and related charges for cost of services). Smoke/ heat detectors fitted as standard.

MANAGEMENT & SECURITY

Management located in the central estate management office. Video entry phone system connected to main entrance door. CCTV system provided to cover the whole estate.

PARKING

Limited car parking at extra cost and subject to availability.

ELEVATORS

Elevators serve all floors.

EXTERNAL

Ground-level areas laid out and finished with a combination of architect-designed hard and soft landscaping with feature lighting.

LEISURE FACILITIES

Health club with heated outdoor swimming pool, steam room, sauna, gymnasium and exercise areas.

NOTE

Main structure, building envelope, floors, roof, windows, stairs, walls and balconies to properties in retailed structures may vary due to the existing building fabric and construction methodology adopted.

Notes

Fragrant
barbeque

smoke

tickles the
appetite

awake

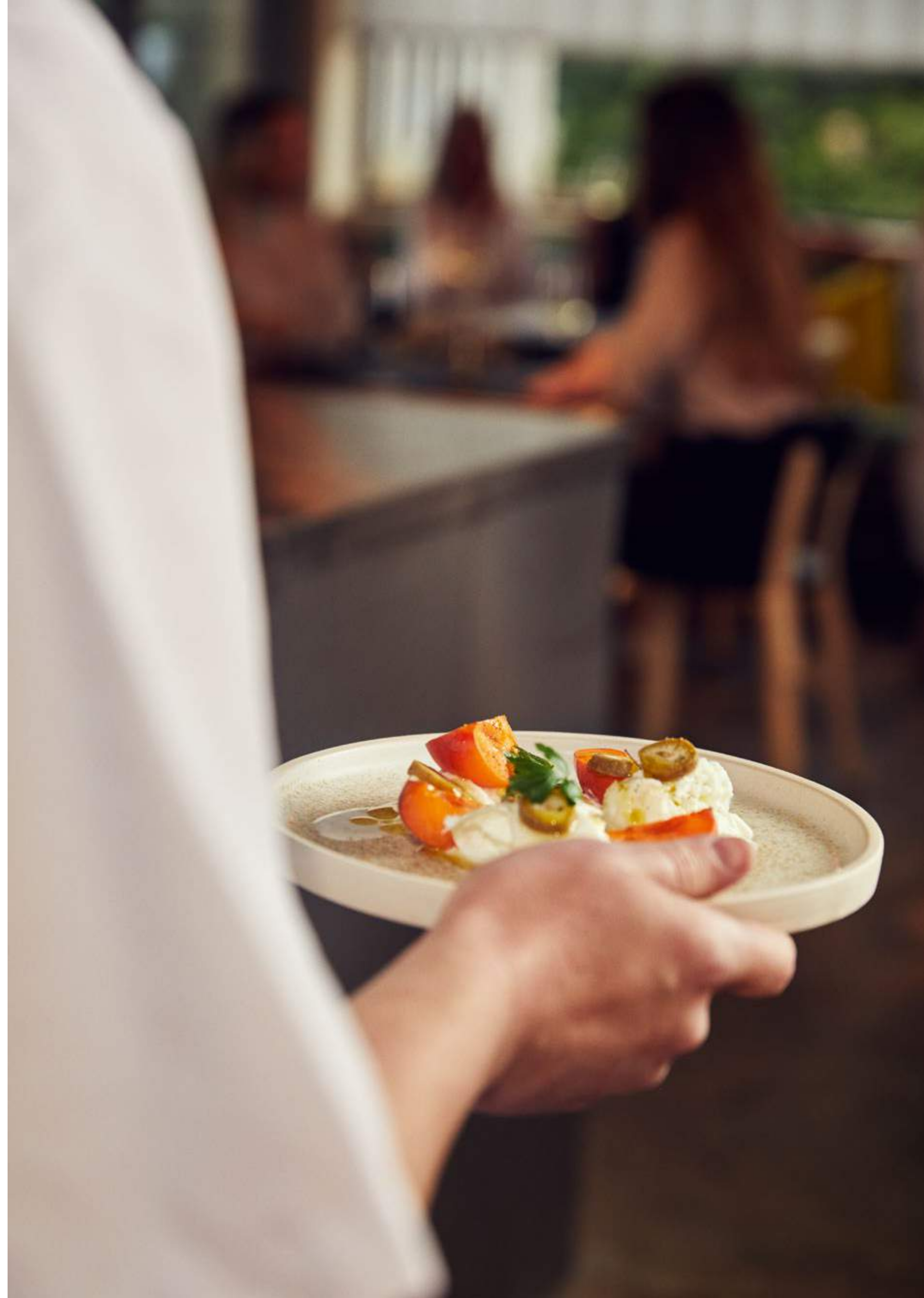

ballymore.